

**GE500-DW-2RS2-W11-XL**

## Spherical plain bearing

Large radial spherical plain bearing, maintenance-free, sliding layer: ELGOGLIDE, inner ring curved surface with hard chromium coating, DIN ISO 12240-1, dimension series C, sealed

X-life

## Technical information

## Your current product variant

Maintenance	Maintenance free	
Sealing	2RS2	Lip seals with increased sealing action on both sides
Bore lining	Without	
Coating	Without	
Fabric	W11	For low contact pressures (starting as low as 1 N/mm <sup>2</sup> ) and minimal friction
Material	Steel	

## Main Dimensions &amp; Performance Data

d	500 mm	Bore diameter bearing
C <sub>r</sub>	29.300.000 N	Basic dynamic load rating, radial
D	670 mm	Outside diameter bearing
B	230 mm	Width inner ring
C	195 mm	Width Outer ring
C <sub>0r</sub>	48.800.000 N	Basic static load rating, radial
≈m	243,1 kg	Weight

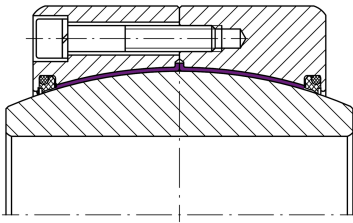



### Mounting dimensions

$r_{1\text{min}}$	2 mm	Edge Spacing
$r_{2\text{min}}$	5 mm	Edge Spacing
$D_{\text{amin}}$	557 mm	Housing Connection Diameter
$d_{\text{amax}}$	537,8 mm	Connection measurement, inner ring

### Dimensions

$d_{\kappa}$	585 mm	Ball diameter
$\alpha$	3,6 °	Tilt angle
$D_{\text{OT}}$	0 mm	Outside diameter, upper tolerance
$D_{\text{UT}}$	-0,075 mm	Outside diameter, lower tolerance
$B_{\text{OT}}$	0 mm	Width inner ring, upper tolerance
$d_{\text{UT}}$	-0,045 mm	Bore diameter bearing, lower tolerance
$B_{\text{UT}}$	-0,45 mm	Width inner ring, lower tolerance
$d_{\text{OT}}$	0 mm	Bore diameter bearing, upper tolerance
$C_{\text{OT}}$	0 mm	Width outer ring, upper tolerance
$C_{\text{UT}}$	-1,1 mm	Width outer ring, lower tolerance
$G_{\text{r}}$	0 - 0,145	Radial Clearance
$G_{\text{rmax}}$	0,145 mm	Radial clearance, maximum
$G_{\text{rmin}}$	0 mm	Radial clearance, minimum

### Temperature range

$T_{\text{min}}$	-40 °C	Operating temperature min.
$T_{\text{max}}$	120 °C	Operating temperature max.



## Characteristics

---

-  Radial load
-  Axial load in one direction
-  Axial load in two directions
-  Lifetime lubrication, freedom from maintenance
-  Sealed on both sides
-  Large bearing
-  Static angular error and misalignment
-  Dynamic angular error and misalignment