**LFCL42**

hollow section carriage

hollow section carriage, clearance-free

Technical information

Your current product variant

Size code 42

Main Dimensions & Performance Data

H₁ 38,1 mm

B 116 mm

L 150 mm

≈m 1 kg Weight

Mounting dimensions

G₄ M8x12mm

H 39 mm Total height of carriage and rail at LFS, -C, -CE, -CEE, -E, -EE, -N, -NZZ

H 33,9 mm Total height of carriage and rail at LFS.-M

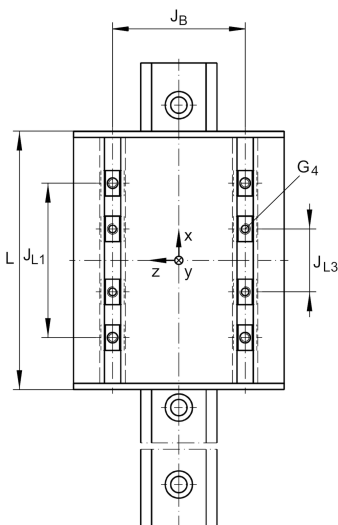
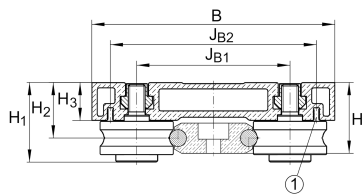
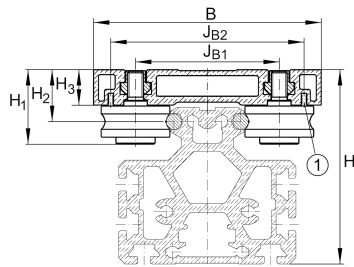
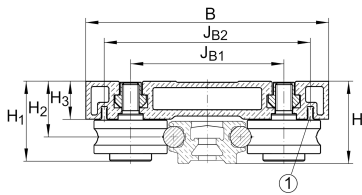
H₂ 26,4 mmH₂ Tol 0,3H₂ Tol 0H₃ 18 mmJ_B 73 mmJ_{B1} 73 mmJ_{B2} 98,5 mmJ_{L1} 85 mmJ_{L3} max 55 mmJ_{L3} min 15 mm



View product details on medias

21.05.2026, 19:18:49 UTC

SCHAEFFLER

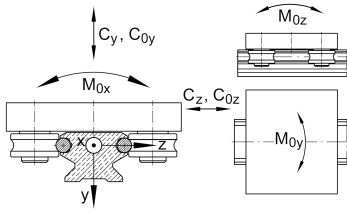

Main dimensions

C_y	10.200 N	Basic dynamic load rating in y-direction
C_{0y}	5.480 N	Basic static load rating in y-direction
C_z	16.900 N	Basic dynamic load rating in z-direction
C_{0z}	10.000 N	Basic static load rating in z-direction
M_{0x}	85 Nm	Static moment about X-axis
M_{0y}	425 Nm	Static moment about Y-axis
M_{0z}	230 Nm	Static moment about Z-axis

Related products

LFR	LFR5201-10-2Z	Used track roller
LFS	LFS42	Guide rail