

LFL20-SF

Carriage

open carriage, standard design, clearance-free

Technical information

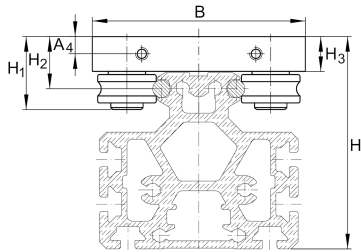
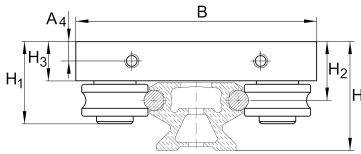

Your current product variant

Size code	20
Setting	SF Clearance-free

Main Dimensions & Performance Data

H ₁	20,5 mm
B	55 mm
L	50 mm
≈m	0,16 kg Weight

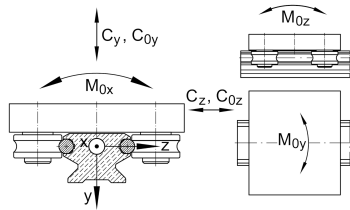
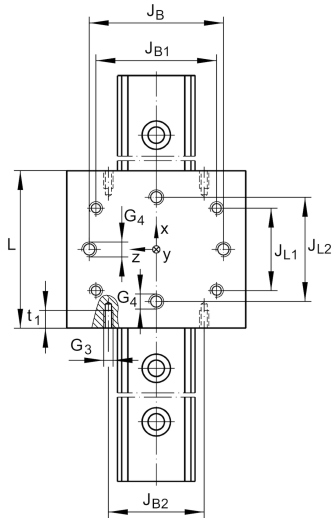

Mounting dimensions

G 3	M3	
G 4	M5	
H	22 mm	Total height of carriage and rail at LFS...F, -FE
H 2	13 mm	
H 2 Tol	0,3	
H 2 Tol	0	
H 3	9 mm	
J B	40 mm	
J B Tol	0,2	
J B Tol	-0,2	
J B1	34 mm	
J L1	24 mm	
J L2	38 mm	
J L2 Tol	0,2	
J L2 Tol	-0,2	

Main dimensions

M A	2,5 Nm	Tightening torque (standard version)
M A	2,5 Nm	Tightening torque (corrosion-resistant version)
C y	1.350 N	Basic dynamic load rating in y-direction
C 0y	870 N	Basic static load rating in y-direction
C z	2.400 N	Basic dynamic load rating in z-direction
C 0z	1.700 N	Basic static load rating in z-direction
M 0x	7 Nm	Static moment about X-axis
M 0y	20 Nm	Static moment about Y-axis
M 0z	10 Nm	Static moment about Z-axis



View product details on medias

30.04.2026, 12:40:27 UTC

SCHAEFFLER

Related products

LFR	LFR50/5-4-2Z	Used track roller
LFS	LFS20	Guide rail