

### GWN30-B [↗](#)

Shaft block

Shaft block

## Technical information

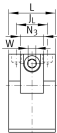
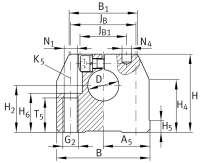

### Your current product variant

Size code	30
Version	B

### Main Dimensions & Performance Data

D	30 mm	Diameter
Tol D	H8	Tolerance
B	87 mm	Width
L	40 mm	Length
H	70 mm	Height
≈m	0,45 kg	Weight



### Mounting dimensions

J <sub>B</sub>	64 mm	Mounting Dimension
Tol J <sub>B</sub>	+ 0,15 mm	Upper tolerance
Tol J <sub>B</sub>	- 0,15 mm	Lower tolerance
J <sub>B1</sub>	45 mm	Mounting Dimension
B <sub>1</sub>	63 mm	Mounting Dimension
A <sub>5</sub>	43,5 mm	Mounting Dimension
Tol A <sub>5</sub>	- 0,01 mm	Lower tolerance
Tol A <sub>5</sub>	+ 0,01 mm	Upper tolerance
J <sub>L</sub>	26 mm	Mounting Dimension
H <sub>2</sub>	40 mm	Mounting Dimension
Tol H <sub>2</sub>	+ 0,01 mm	Upper tolerance
Tol H <sub>2</sub>	- 0,01 mm	Lower tolerance
H <sub>4</sub>	46,2 mm	Mounting Dimension
H <sub>5</sub>	9,3 mm	Mounting Dimension
T <sub>5</sub>	26 mm	Mounting Dimension
H <sub>6</sub>	4 mm	Mounting Dimension
G <sub>2</sub>	M12	Mounting thread below
N <sub>1</sub>	10,5 mm	Mounting Dimension
N <sub>3</sub>	18 mm	Mounting Dimension
N <sub>4</sub>	8 mm	Mounting Dimension
K <sub>5</sub>	M10	Size thread fixing screws above
W	6 mm	Width across Flat