

LFL32-SF [↗](#)

Carriage

non-locating bearing carriage, clearance-free

Technical information

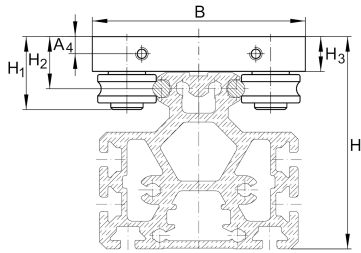
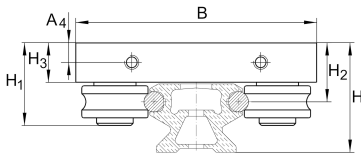

Your current product variant

Size code	32
Setting	SF

Main Dimensions & Performance Data

H ₁	32,5 mm	
B	80 mm	
L	90 mm	
≈m	0,42 kg	Weight

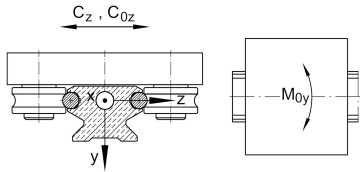
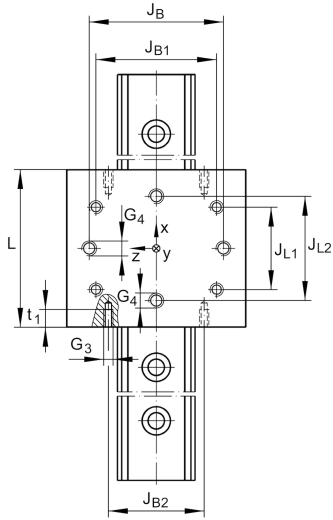
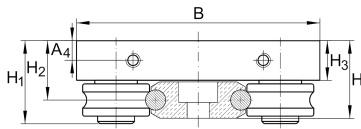

Mounting dimensions

A 4	7 mm	
G 3	M6	
G 4	M8	
H	35,5 mm	Total height of carriage and rail at LFS, -C, -CE, -CEE, -E, -EE, -N, -NZZ
H	25,5 mm	Total height of carriage and rail at LFS.-F, -FE
H	81,5 mm	Total height of carriage and rail at LFS.-M
H 2	20,5 mm	
H 2 Tol	0,5	
H 2 Tol	-0,5	
H 3	13,75 mm	
J B	59 mm	
J B Tol	0,2	
J B Tol	-0,2	
J B1	54 mm	
J B2	56 mm	
J L1	60 mm	
J L2	70 mm	
J L2 Tol	0,2	
J L2 Tol	-0,2	
t 1	7 mm	

Main dimensions

C z	9.000 N	Basic dynamic load rating in z-direction
C 0z	8.000 N	Basic static load rating in z-direction
M 0y	250 Nm	Static moment about Y-axis



View product details on medias

26.04.2026, 06:03:07 UTC

SCHAEFFLER

Related products

LFR	LFR22/8-6-2RSR- RNA+IR.LFLL32	Used track roller
LFS	LFS32	Guide rail