



IMAGE COMING SOON



### RUKS35-D-A-H-SR [↗](#)

Braking/clamping element

Clamping element RUKS...D-A-H-SR, for linear recirculating roller bearing and guideway assembly, oil connector on side

## Technical information

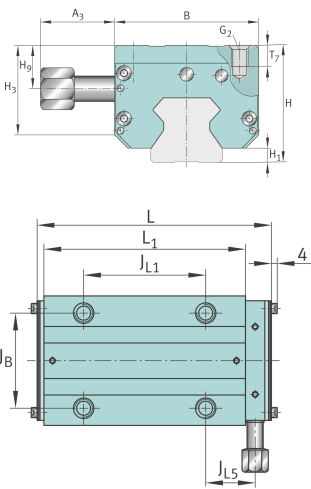

### Your current product variant

Size code	35	
Version	D	
Internal design	A	
Carriage design	H	High carriage
Oil feed	SR	Oil connector on side

### Main Dimensions & Performance Data

H	55 mm	Height system
B	68 mm	Width clamping element
L	134,3 mm	Length of clamping element
≈m	2,3 kg	Weight



### Mounting dimensions

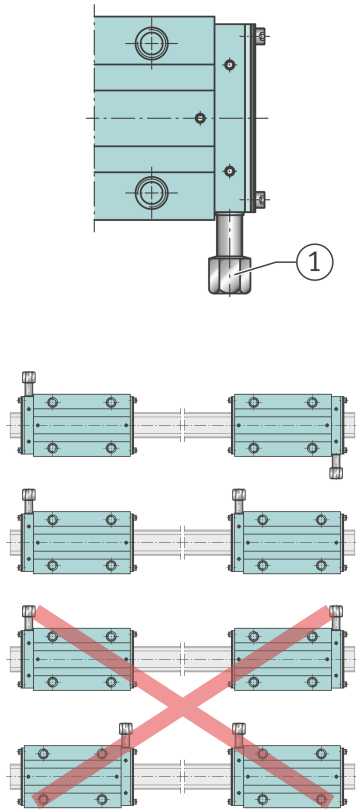

J <sub>B</sub>	50 mm	Hole pattern width
A <sub>3</sub>	39,5 mm	Mounting dimension oil connector
L <sub>1</sub>	113 mm	Length saddle plate
J <sub>L1</sub>	50 mm	Hole pattern lengthwise
J <sub>L5</sub>	38 mm	Distance
N <sub>2 max</sub>	6 mm	Max diameter lubrication hole adjacent constr
H <sub>1</sub>	6,8 mm	Space (system)
H <sub>3</sub>	42 mm	
T <sub>7</sub>	10 mm	Depth thread
H <sub>9</sub>	20,4 mm	
G <sub>2</sub>	M8	Size thread above for DIN ISO 4762-12.9
M G <sub>2</sub>	41 Nm	Tightening torque above

### Related products

TSX35-E; TSX35-F	Suitable guideway
RUE35-E; RUE35-F	Suitable system