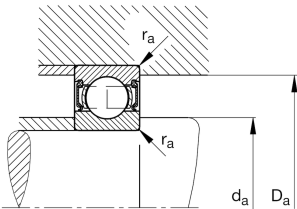
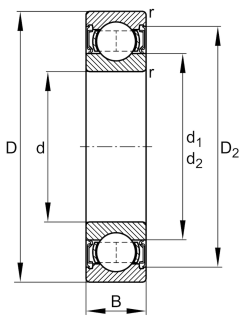

**FAG****6306-2RSR-N**

Deep groove ball bearing

Deep groove ball bearing 63...2RSR-N, single row, seals, ring groove, steel sheet metal cage

Technical information

**Your current product variant**

Type of Seal	2RSR	Contact seal on both sides
Design, bearing outer ring	N	Ring groove for snap ring
Cage	JN	Steel sheet metal
Tolerance class	PN	Normal (ISO 492:2023)
Dimensional / heat stabilization	SN	Rings dimensional stabilized up to 120°
Lubricant	GA13	Ball bearing and insert bearing grease
Radial internal clearance	CN (Group N)	Normal internal clearance
Bore type	Z	Cylindrical

Main Dimensions & Performance Data

d	30 mm	Bore diameter
D	72 mm	Outside diameter
B	19 mm	Width
C _r	30.500 N	Basic dynamic load rating, radial
C _{0r}	16.200 N	Basic static load rating, radial
C _{ur}	1.050 N	Fatigue load limit, radial
n _G	6.000 1/min	Limiting speed
≈m	0,352 kg	Weight



Mounting dimensions

$d_{a \min}$	37 mm	Minimum diameter shaft shoulder
$D_{a \max}$	65 mm	Maximum diameter of housing shoulder
$r_{a \max}$	1 mm	Maximum fillet radius

Dimensions

r_{\min}	1,1 mm	Minimum chamfer dimension
D_1	59,62 mm	Shoulder diameter outer ring
D_2	61,58 mm	Caliber diameter outer ring
d_1	44,6 mm	Shoulder diameter inner ring





Temperature range

T_{\min}	-20 °C	Operating temperature min.
T_{\max}	100 °C	Operating temperature max.

Calculation factors

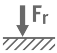
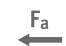
f_0	13	Calculation factor
-------	----	--------------------

Characteristics

	Radial load
	Axial load in one direction
	Axial load in two directions
	Lifetime lubrication, freedom from maintenance
	Grease Lubrication
	Sealed on both sides