**FAG****SNS3140-B-D**

## Plummer block housing

Plummer block housing, split, for spherical roller bearings, metric shaft diameters, Bolt-On design, for grease lubrication

## Technical information

## Your current product variant

Material	D	Spheroidal graphite cast iron
----------	---	-------------------------------

## Main Dimensions &amp; Performance Data

$h_1$	411 mm	Housing height
$g$	280 mm	Housing width
$a$	610 mm	Length base
$\approx m$	123,1 kg	Weight

## Dimensions

$c$	85 mm	Base height
$b$	230 mm	Base width
$n_2$	130 mm	Base hole distance 2
$D$	340 mm	Bearing seat
$e$	10 mm	Center offset
$h$	210 mm	Center height
$k$	132 mm	Bearing seat width
$m$	510 mm	Base hole distance 1
$s$	M30	Screw size base hole fixing
$u$	35 mm	Base hole width
$v$	43 mm	Base hole length

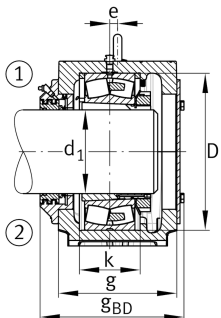
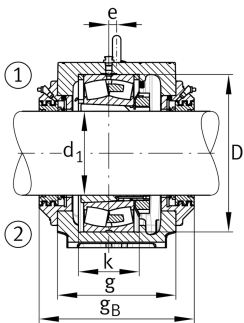
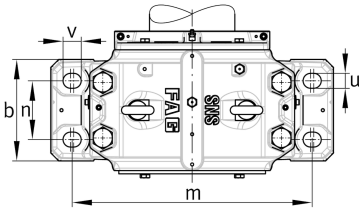
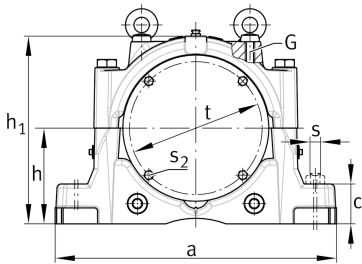



View product details on medias

17.05.2026, 19:36:05 UTC

SCHAEFFLER

