**FAG****SNS3160-B-D**

Plummer block housing

Plummer block housing, split, for spherical roller bearings, metric shaft diameters, Bolt-On design, for grease lubrication

Technical information

Your current product variant

Material	D	Spheroidal graphite cast iron
----------	---	-------------------------------

Main Dimensions & Performance Data

h_1	591 mm	Housing height
g	350 mm	Housing width
a	830 mm	Length base
$\approx m$	304,8 kg	Weight

Dimensions

c	110 mm	Base height
b	310 mm	Base width
n_2	190 mm	Base hole distance 2
D	500 mm	Bearing seat
e	22 mm	Center offset
h	300 mm	Center height
k	180 mm	Bearing seat width
m	710 mm	Base hole distance 1
s	M36	Screw size base hole fixing
u	42 mm	Base hole width
v	50 mm	Base hole length

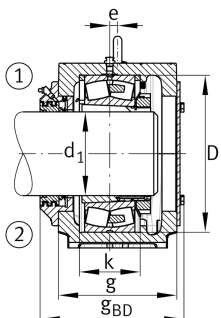
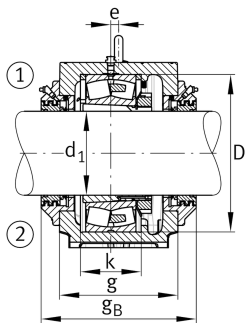
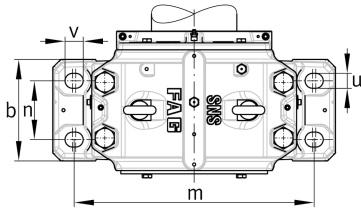
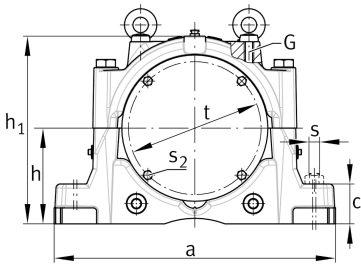



View product details on medias

20.05.2026, 00:26:32 UTC

SCHAEFFLER

