

**PTUE40-XL**

Take-up housing unit

Take-up housing units PTUE, cast iron housing, radial insert ball bearing with eccentric locking collar, P seals

X-life

Technical information

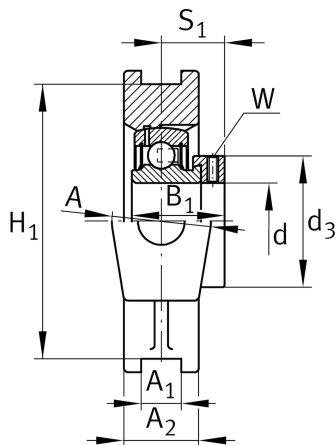

Your current product variant

Material	GG	Grey cast iron
----------	----	----------------

Main Dimensions & Performance Data

d	40 mm	Bore diameter
H	115 mm	Height
L	141 mm	Length total
B ₁	43,8 mm	Locking collar total width
m	2,43 kg	Weight

Mounting dimensions

A ₁	16 mm	Width guidance groove
	H13	Width guidance groove clearance
H ₁	102 mm	Distance guidance grooves
	0,15 mm	Upper distance guidance groove tolerance
	-0,15 mm	Lower distance guidance groove tolerance
N	29 mm	Fixing bore



Dimensions

L ₁	88 mm	Distance shaft axis
L ₂	16 mm	Length fixed link
L ₃	82 mm	Length guidance groove
A	50 mm	Width housing fixing side
N ₁	20 mm	Width recess
N ₂	49 mm	Height recess
S ₁	32,8 mm	Distance of raceway to locking collar
T	82 mm	Height housing fixing side
Q	M6	Connection thread for lubrication
A ₂	35 mm	Width housing

Additional information

TUE08	Housing
GRAE40-XL-NPP-B	Bearing designation

Temperature range

T _{min}	-20 °C	Operating temperature min.
T _{max}	120 °C	Operating temperature max.