

**MHA395-0-2-3-4-N-1530-01,0M-8-1-A** [↗](#)

sensing head

Measuring heads, for radial screw mounting

Technical information

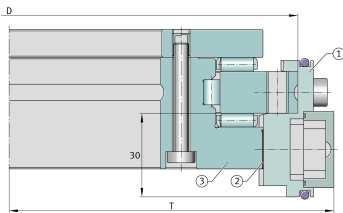

Your current product variant

Cable length 1 m

Digital Output

| | Drive CLIQ (DQ) | Electronic interface |
|----|-----------------|----------------------|
| ≈m | 133,77 g | Weight |

Main Dimensions & Performance Data

| | | |
|----------------|--------|-----------------------------|
| D | 525 mm | Diameter bearing outer ring |
| H _M | 54 mm | Height |

Mounting dimensions

| | | |
|----------------|----------|--|
| J _M | 34 mm | Bore distance |
| T | 275,7 mm | Distance bearing center measuring head |

Additional information

| | |
|----------------------|-----------------------------------|
| 5 Nm | Tightening torque |
| 0,5 Nm | Tightening torque upper tolerance |
| -0,5 Nm | Tightening torque lower tolerance |
| 2x ISO4762-M6x20-8.8 | Cylinder head screws |



View product details on medias

20.04.2026, 10:59:36 UTC

SCHAEFFLER

Cable

| | |
|-------|-----------------------|
| M12x1 | Thread plug connector |
| 8 | Pins plug connector |