

**PCF50-XL**

Flanged housing unit

Housing units PCF, four-bolt flanged housing units, cast iron, eccentric locking collar, P seals

X-life

Technical information

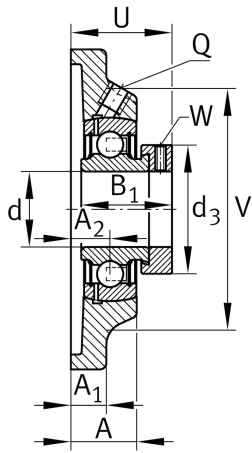

Your current product variant

| | | |
|----------|----|----------------|
| Material | GG | Grey cast iron |
|----------|----|----------------|

Main Dimensions & Performance Data

| | | |
|-----------------|----------|-----------------------------------|
| d | 50 mm | Bore diameter |
| L | 143 mm | Flange width |
| U | 52 mm | Total height unit |
| C _r | 37.500 N | Basic dynamic load rating, radial |
| C _{0r} | 23.200 N | Basic static load rating, radial |
| C _{ur} | 1.090 N | Fatigue load limit, radial |
| ≈m | 2,18 kg | Weight |

Mounting dimensions

| | | |
|---|--------|--------------------------|
| J | 111 mm | Distance fixing bore |
| N | 14 mm | Fixing bore |
| n | 4 | Number of screwing holes |



Dimensions

| | | |
|----------------|---------|-----------------------------------|
| A | 30,2 mm | Height housing |
| A ₁ | 13 mm | Thickness of flange |
| A ₂ | 19,2 mm | Distance raceway |
| V | 125 mm | Shoulder diameter housing |
| Q | M6 | Connection thread for lubrication |
| d ₃ | 69 mm | Outside diameter locking device |

Additional information

| | |
|-----------------|---------------------|
| 1 | Number of housings |
| CF10 | Housing |
| GRAE50-XL-NPP-B | Bearing designation |

Temperature range

| | | |
|------------------|--------|----------------------------|
| T _{min} | -20 °C | Operating temperature min. |
| T _{max} | 120 °C | Operating temperature max. |