

**LCJT45-XL**

## Flanged housing unit

Housing units LCJT, two-bolt flanged housing units, cast iron, eccentric locking collar, L seals, for temperatures from -40°C to +180°C

X-life

## Technical information

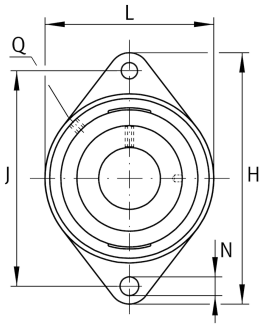

## Your current product variant

Material	GG	Grey cast iron
----------	----	----------------

## Main Dimensions &amp; Performance Data

d	45 mm	Bore diameter
L	111 mm	Flange width
H	180 mm	Height flange
U	59,1 mm	Total height unit
C <sub>r</sub>	34.500 N	Basic dynamic load rating, radial
C <sub>0r</sub>	20.400 N	Basic static load rating, radial
C <sub>ur</sub>	970 N	Fatigue load limit, radial
≈m	1,92 kg	Weight

## Mounting dimensions

J	148,5 mm	Distance fixing bore
N	14 mm	Fixing bore
n	2	Number of screwing holes



### Dimensions

A	35 mm	Height housing
A <sub>1</sub>	13 mm	Thickness of flange
A <sub>2</sub>	24 mm	Distance raceway
V	111 mm	Shoulder diameter housing
Q	M6	Connection thread for lubrication

### Additional information

1	Number of housings
CJT09	Housing
GE45-XL-KLL-B	Bearing designation

### Temperature range

T <sub>min</sub>	-40 °C	Operating temperature min.
T <sub>max</sub>	180 °C	Operating temperature max.