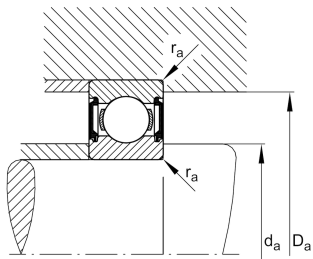
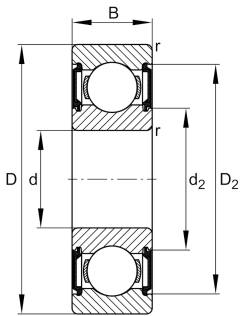

**FAG****6001-C-2BRS>V**

Deep groove ball bearing

Deep groove ball bearing 60...-C-2BRS, single row, Generation C, shields, steel sheet metal cage

Technical information

**Your current product variant**

Version code	>V	Not marked on bearing
Changed internal design	C	GenerationC
Sealing	2BRS	Non-contact seal on both sides
Cage	JN	Steel sheet metal
Tolerance class	P6	Class 6 (ISO 492:2023)
Dimensional / heat stabilization	SN	Rings dimensional stabilized up to 120°
Lubricant	GA14	Ball bearing grease, low noise
Radial internal clearance	CN (Group N)	Normal internal clearance
Bore type	Z	Cylindrical

Main Dimensions & Performance Data

d	12 mm	Bore diameter
D	28 mm	Outside diameter
B	8 mm	Width
C _r	5.900 N	Basic dynamic load rating, radial
C _{0r}	2.370 N	Basic static load rating, radial
C _{ur}	164 N	Fatigue load limit, radial
n _G	36.000 1/min	Limiting speed
n _{gr}	26.000 1/min	Reference speed
≈m	0,02 kg	Weight



Mounting dimensions

$d_{a \min}$	14 mm	Minimum diameter shaft shoulder
$D_{a \max}$	26 mm	Maximum diameter of housing shoulder
$r_{a \max}$	0,3 mm	Maximum fillet radius

Dimensions

r_{\min}	0,3 mm	Minimum chamfer dimension
D_1	23,34 mm	Shoulder diameter outer ring
D_2	25,1 mm	Caliber diameter outer ring
d_1	16,66 mm	Shoulder diameter inner ring
d_2	15,69 mm	Caliber diameter inner ring

Temperature range

T_{\min}	-20 °C	Operating temperature min.
T_{\max}	100 °C	Operating temperature max.

Calculation factors

f_0	13,1	Calculation factor
-------	------	--------------------

Characteristics

	Radial load
	Axial load in one direction
	Axial load in two directions
	Lifetime lubrication, freedom from maintenance
	Grease Lubrication
	Sealed on both sides