

**RCJY60-XL-N**

## Flanged housing unit

Housing units RCJY, four-bolt flanged housing units, cast iron, grub screws in inner ring, R seals

X-life

## Technical information

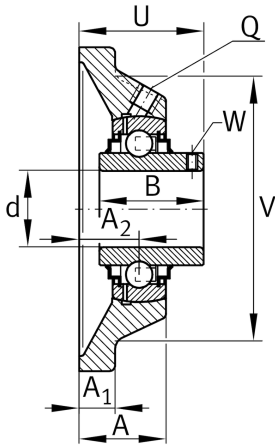
**Your current product variant**

|          |    |   |
|----------|----|---|
| Groove   | N  | Cast iron housing with undercut slot for end caps |
| Material | GG | Grey cast iron                                    |

**Main Dimensions & Performance Data**

|                 |          |                                   |
|-----------------|----------|-----------------------------------|
| d               | 60 mm    | Bore diameter                     |
| L               | 175 mm   | Flange width                      |
| U               | 73,7 mm  | Total height unit                 |
| C <sub>r</sub>  | 56.000 N | Basic dynamic load rating, radial |
| C <sub>0r</sub> | 36.000 N | Basic static load rating, radial  |
| C <sub>ur</sub> | 1.870 N  | Fatigue load limit, radial        |
| m               | 3,929 kg | Weight                            |

**Mounting dimensions**

|   |        |                          |
|---|--------|--------------------------|
| J | 143 mm | Distance fixing bore     |
| N | 18 mm  | Fixing bore              |
| n | 4      | Number of screwing holes |



### Dimensions

|                |         |                                   |
|----------------|---------|-----------------------------------|
| A              | 47,5 mm | Height housing                    |
| A <sub>1</sub> | 16 mm   | Thickness of flange               |
| A <sub>2</sub> | 34 mm   | Distance raceway                  |
| B              | 65,1 mm | Width                             |
| V              | 150 mm  | Shoulder diameter housing         |
| Q              | M6      | Connection thread for lubrication |

### Additional information

|                |                     |
|----------------|---------------------|
| 1              | Number of housings  |
| CJ12           | Housing             |
| GYE60-XL-KRR-B | Bearing designation |
| KASK12         | Protecting cap      |

### Temperature range

|                  |        |                            |
|------------------|--------|----------------------------|
| T <sub>min</sub> | -20 °C | Operating temperature min. |
| T <sub>max</sub> | 120 °C | Operating temperature max. |