

**PASEY60-XL-N**

Plummer block housing unit

Plummer block housing units PASEY, cast iron housing, radial insert ball bearing with grub screws in inner ring, P seals

X-life

Technical information

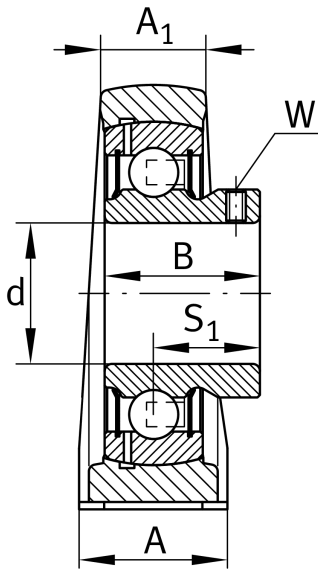

Your current product variant

| | | |
|----------|----|---|
| Material | GG | Grey cast iron |
| Groove | N | Cast iron housing with undercut slot for end caps |

Main Dimensions & Performance Data

| | | |
|----------------|---------|---------------|
| d | 60 mm | Bore diameter |
| L | 240 mm | Length total |
| H ₂ | 140 mm | Height |
| ≈m | 4,13 kg | Weight |

Mounting dimensions

| | | |
|----------------|--------|----------------------|
| J | 190 mm | Distance fixing bore |
| N | 18 mm | Width (slot) |
| N ₁ | 28 mm | Length (slot) |



Dimensions

| | | |
|----------------|---------|---------------------------------------|
| H | 69,9 mm | Distance shaft axis |
| A | 60 mm | Width (base) |
| A ₁ | 42 mm | Width (head) |
| H ₁ | 25 mm | Height (base) |
| B | 47 mm | Width |
| S ₁ | 34 mm | Distance of raceway to locking collar |
| Q | M6 | Connection thread for lubrication |

Additional information

| | |
|----------------|---------------------|
| ASE12 | Housing |
| GAY60-XL-NPP-B | Bearing designation |
| KASK12 | Protecting cap |

Temperature range

| | | |
|------------------|--------|----------------------------|
| T _{min} | -20 °C | Operating temperature min. |
| T _{max} | 120 °C | Operating temperature max. |