

**TCJT50-XL-N**

## Flanged housing unit

Housing units TCJT, two-bolt flanged housing units, cast iron, eccentric locking collar, T seals

X-life

## Technical information

## Your current product variant

Groove	N	Cast iron housing with undercut slot for end caps
Material	GG	Grey cast iron

## Main Dimensions &amp; Performance Data

d	50 mm	Bore diameter
L	116 mm	Flange width
H	190 mm	Height flange
U	66,2 mm	Total height unit
$C_r$	37.500 N	Basic dynamic load rating, radial
$C_{0r}$	23.200 N	Basic static load rating, radial
$C_{ur}$	990 N	Fatigue load limit, radial
$\approx m$	2,24 kg	Weight

## Mounting dimensions

J	157 mm	Distance fixing bore
N	18 mm	Fixing bore
n	2	Number of screwing holes
W	5 mm	Width of flats

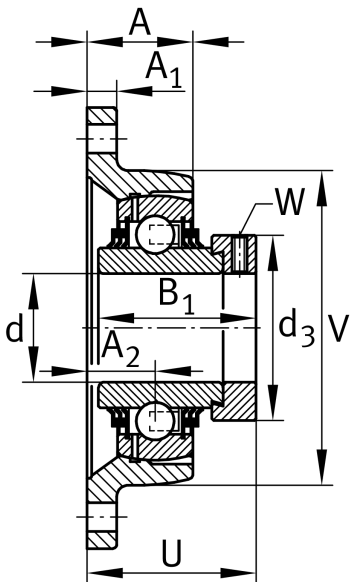
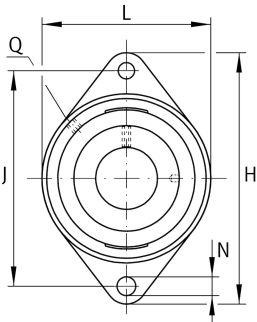



### Dimensions

A	39 mm	Height housing
A <sub>1</sub>	13 mm	Thickness of flange
A <sub>2</sub>	28 mm	Distance raceway
B <sub>1</sub>	62,8 mm	Locking collar total width
V	116 mm	Shoulder diameter housing
Q	M6	Connection thread for lubrication
d <sub>3</sub>	69 mm	Outside diameter locking collar

### Additional information

1	Number of housings
CJT10	Housing
GE50-XL-KTT-B	Bearing designation
KASK10	Protecting cap

### Temperature range

T <sub>min</sub>	-20 °C	Operating temperature min.
T <sub>max</sub>	120 °C	Operating temperature max.