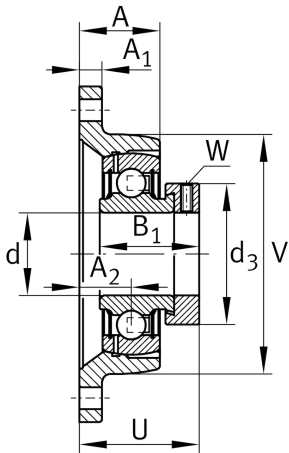
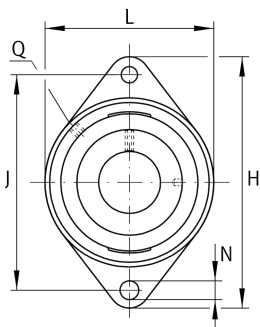

**PCJT50-N-FA125.8** [↗](#)

Flanged housing unit

## Technical information

**Your current product variant**

Groove	N	Cast iron housing with undercut slot for end caps
Material	GG	Grey cast iron
Manufacturing instruction	FA125.8	Housing with Corroprotect coating

**Main Dimensions & Performance Data**

d	50 mm	Bore diameter
L	116 mm	Flange width
H	190 mm	Height flange
U	60,8 mm	Total height unit
C <sub>r</sub>	37.500 N	Basic dynamic load rating, radial
C <sub>0r</sub>	23.200 N	Basic static load rating, radial
≈m	1,97 kg	Weight

**Mounting dimensions**

J	157 mm	Distance fixing bore
N	18 mm	Fixing bore
n	2	Number of screwing holes
W	5 mm	Width of flats



### Dimensions

A	41 mm	Height housing
A <sub>1</sub>	13 mm	Thickness of flange
A <sub>2</sub>	28 mm	Distance raceway
B <sub>1</sub>	43,8 mm	Locking collar total width
V	116 mm	Shoulder diameter housing
Q	M6	Connection thread for lubrication
d <sub>3</sub>	69 mm	Outside diameter locking collar

### Additional information

GEHCJT10-GG-N-FA125.1	Housing
GRAE50-XL-NPP-B	Bearing designation

### Temperature range

T <sub>min</sub>	-20 °C	Operating temperature min.
T <sub>max</sub>	120 °C	Operating temperature max.