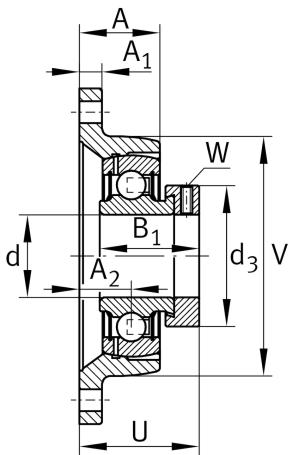

IMAGE  
COMING SOON**PCFT50-FA125**

Flanged housing unit

Flanged housing unit PCFT

## Technical information

**Your current product variant**

Material	GG	Grey cast iron
Manufacturing instruction	FA125	Unit with Corrotect coating, corrosion-resistant

**Main Dimensions & Performance Data**

d	50 mm	Bore diameter
L	116 mm	Flange width
H	190 mm	Height flange
U	52 mm	Total height unit
C <sub>r</sub>	37.500 N	Basic dynamic load rating, radial
C <sub>0r</sub>	23.200 N	Basic static load rating, radial
C <sub>ur</sub>	1.090 N	Fatigue load limit, radial
≈m	1,73 kg	Weight

**Mounting dimensions**

J	157 mm	Distance fixing bore
N	14 mm	Fixing bore
n	2	Number of screwing holes
W	5 mm	Width of flats



### Dimensions

A	30,2 mm	Height housing
A <sub>1</sub>	13 mm	Thickness of flange
A <sub>2</sub>	19,2 mm	Distance raceway
B <sub>1</sub>	43,8 mm	Locking collar total width
V	116 mm	Shoulder diameter housing
Q	M6	Connection thread for lubrication
d <sub>3</sub>	69 mm	Outside diameter locking collar

### Additional information

1	Number of housings
GEHCFT10-GG-FA125.1	Housing
GRAE50-XL-NPP-B-FA125.5	Bearing designation

### Temperature range

T <sub>min</sub>	-20 °C	Operating temperature min.
T <sub>max</sub>	120 °C	Operating temperature max.