

**RCJT60-XL-N**

Flanged housing unit

Housing units RCJT, two-bolt flanged housing units, cast iron, eccentric locking collar, R seals

X-life

Technical information

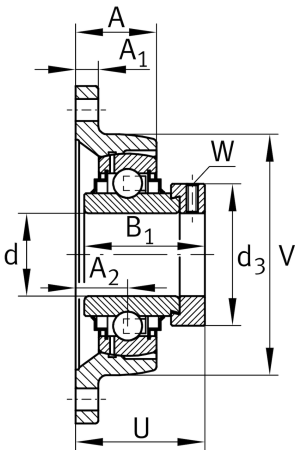

Your current product variant

Groove	N	Cast iron housing with undercut slot for end caps
Material	GG	Grey cast iron

Main Dimensions & Performance Data

d	60 mm	Bore diameter
L	138 mm	Flange width
H	238 mm	Height flange
U	80,8 mm	Total height unit
C _r	56.000 N	Basic dynamic load rating, radial
C _{0r}	36.000 N	Basic static load rating, radial
C _{ur}	1.710 N	Fatigue load limit, radial
≈m	3,869 kg	Weight

Mounting dimensions

J	202 mm	Distance fixing bore
N	18 mm	Fixing bore
n	2	Number of screwing holes
W	5 mm	Width of flats



Dimensions

A	46 mm	Height housing
A ₁	16 mm	Thickness of flange
A ₂	34 mm	Distance raceway
B ₁	77,9 mm	Locking collar total width
V	138 mm	Shoulder diameter housing
Q	M6	Connection thread for lubrication
d ₃	84 mm	Outside diameter locking collar

Additional information

1	Number of housings
CJT12	Housing
GE60-XL-KRR-B	Bearing designation
KASK12	Protecting cap

Temperature range

T _{min}	-20 °C	Operating temperature min.
T _{max}	120 °C	Operating temperature max.