

**RCJY80-XL**

## Flanged housing unit

Housing units RCJY, four-bolt flanged housing units, cast iron, grub screws in inner ring, R seals

X-life

## Technical information

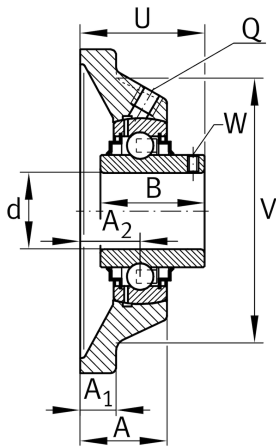

## Your current product variant

Material	GG	Grey cast iron
----------	----	----------------

## Main Dimensions &amp; Performance Data

d	80 mm	Bore diameter
L	197 mm	Flange width
U	90,6 mm	Total height unit
C <sub>r</sub>	76.000 N	Basic dynamic load rating, radial
C <sub>0r</sub>	54.000 N	Basic static load rating, radial
C <sub>ur</sub>	2.190 N	Fatigue load limit, radial
≈m	6,47 kg	Weight

## Mounting dimensions

J	153 mm	Distance fixing bore
N	23 mm	Fixing bore
n	4	Number of screwing holes



### Dimensions

A	56,3 mm	Height housing
A <sub>1</sub>	20 mm	Thickness of flange
A <sub>2</sub>	41,3 mm	Distance raceway
B	82,6 mm	Width
V	180 mm	Shoulder diameter housing
Q	M6	Connection thread for lubrication

### Additional information

1	Number of housings
CJ16	Housing
GYE80-XL-KRR-B	Bearing designation

### Temperature range

T <sub>min</sub>	-20 °C	Operating temperature min.
T <sub>max</sub>	120 °C	Operating temperature max.