**TKVD25-W**

Profile rail

Guideways for four-row linear recirculating ball bearing and guideway assembly KUVE...-W, wide guideway

Technical information

Your current product variant

Size code	25	
Length	~6000	
Guideway design	W	Wide execution

Main Dimensions & Performance Data

h	18,7 mm	Height
b	69 mm	Width
Tol b	-0,005 mm	Upper tolerance
Tol b	-0,035 mm	Lower tolerance
≈m	9,4 kg/m	Weight

Mounting dimensions

K 1	M6	Thread
K1 M _A	17 Nm	Tightening torque
d 1	6,8 mm	Bore diameter

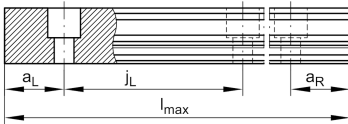
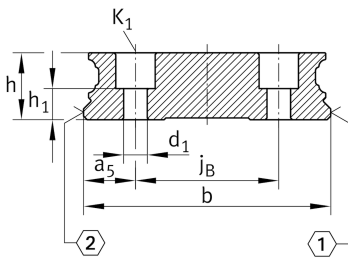



Dimensions

l_{\max}	6.000 mm	Max length single piece guideway
$a_{L \max}$	71 mm	Distance
$a_{L \min}$	20 mm	Distance
$a_{R \max}$	71 mm	Distance
$a_{R \min}$	20 mm	Distance
j_L	80 mm	Increment
j_B	40 mm	Increment
a_5	14,5 mm	Distance
h_1	8,2 mm	Length
Tol h_1	0,5 mm	Upper tolerance
Tol h_1	-0,5 mm	Distance Distance

Additional information

KWVE25-W...	Usable carriage(s)
KUVE25-W...	Usable linear systems