



FAG

SES524-620-L

Plummer block housing

Split plummer block housing for various bearing designs. The SNV series will be replaced by the new SES series in 2022.

Technical information

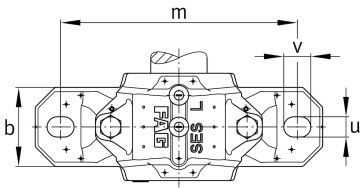

Main Dimensions & Performance Data

D	215 mm	Outside diameter bearing
a	410 mm	Length base
h ₁	271 mm	Height
g	185 mm	Width housing body
K	86 mm	Width bearing seat
≈m	26,2 kg	Weight

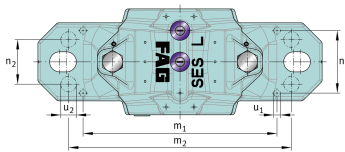
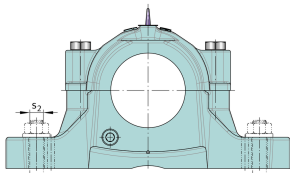
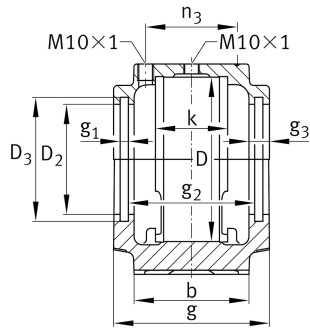
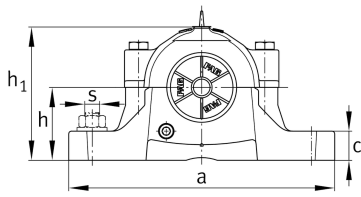

Dimensions

b	120 mm	Width base
c	45 mm	Height base
h	140 mm	Base to shaft centerline height
m	350 mm	Distance fixing bore
s	22,225 mm	Screw size
s	M24	Size of fixing screws
u	26 mm	Width slot
v	32 mm	Length slot
D ₂	157,5 mm	Diameter sealing
D ₃	167,5 mm	Diameter sealing groove
D ₅	164,7 mm	Outside diameter sealing labyrinth
g ₁	6 mm	Width sealing groove
g ₂	163 mm	Distance sealing
g ₃	15 mm	Wall thickness
g ₄	45 mm	Distance oil lubrication
m ₁	300 mm	Distance holes aligned pins m1
n ₃	115 mm	Distance lubrication
n ₄	165 mm	Distance lubrication sealing
u ₁	8 mm	Bore diameter u1
u ₂	18 mm	Bore diameter u2