**KWVE20-B-SN**

## Recirculating ball bearing carriage

Carriages KWVE...-B-SN, narrow, low carriage, four-row

## Technical information

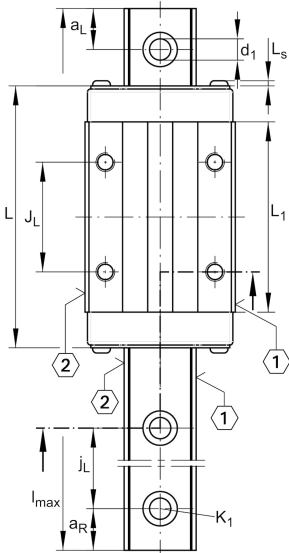
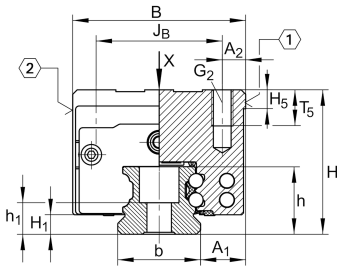

## Your current product variant

Size code	20	
Version	B	
Carriage design	SN	Narrow, low carriage

## Main Dimensions &amp; Performance Data

H	27 mm	Height system
B	44 mm	Width carriage
L	71,4 mm	Overall length carriage
C	13.100 N	Dynamic load rating
C <sub>0</sub>	27.000 N	Static load rating
M <sub>0x</sub>	332 Nm	Static moment rating about X axis
M <sub>0y</sub>	240 Nm	Static moment rating about Y axis
M <sub>0z</sub>	240 Nm	Static moment rating about Z axis
≈m	0,29 kg	Weight

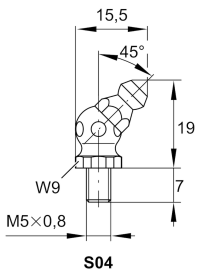
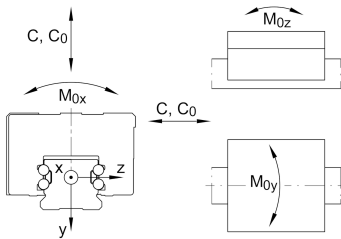
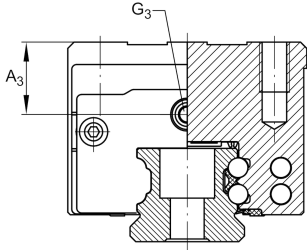

## Mounting dimensions

A <sub>1</sub>	12 mm	Distance from locating edge on carriage to locating edge on guideway
J <sub>B</sub>	32 mm	
b	20 mm	Width rail
A <sub>2</sub>	6 mm	Distance from locating edge to hole
L <sub>1</sub>	50,4 mm	
L <sub>S</sub>	1,3 mm	
J <sub>L</sub>	36 mm	
H <sub>1</sub>	4,5 mm	Free space, system dimension
H <sub>5</sub>	5,25 mm	
T <sub>5</sub>	7,5 mm	Thread depth
G <sub>2</sub>	M5	Fixing screws above (DIN ISO 4762-12.9)
G <sub>2 M<sub>A</sub></sub>	10 Nm	Maximum tightening torque
A <sub>3</sub>	4,7 mm	Position lubrication connector
G <sub>3</sub>	M5	Lubrication connector
t <sub>G<sub>3</sub></sub>	7 mm	Maximum permissible screw depth for lubrication connectors
A <sub>4</sub>	3,3 mm	Position lubrication connector
G <sub>4</sub>	M3	Lubrication connector
t <sub>G<sub>4</sub></sub>	5,5 mm	Maximum permissible screw depth for lubrication connectors
J <sub>L6</sub>	11,4 mm	Position lubrication connector

## Additional information

VMKB_065	KWVE	Material name
----------	------	---------------