

KWVE25-B-SNL

Recirculating ball bearing carriage

Carriages KWVE...-B-SNL, narrow, low, long carriage, four-row

Technical information

Your current product variant

| | |
|-----------------|---|
| Size code | 25 |
| Version | B |
| Carriage design | SNL Narrow, low, long carriage |

Main Dimensions & Performance Data

| | | |
|-----------------|----------|-----------------------------------|
| H | 31 mm | Height system |
| B | 48 mm | Width carriage |
| L | 109,1 mm | Overall length carriage |
| C | 23.400 N | Dynamic load rating |
| C ₀ | 54.000 N | Static load rating |
| M _{0x} | 745 Nm | Static moment rating about X axis |
| M _{0y} | 825 Nm | Static moment rating about Y axis |
| M _{0z} | 825 Nm | Static moment rating about Z axis |
| ≈m | 0,62 kg | Weight |

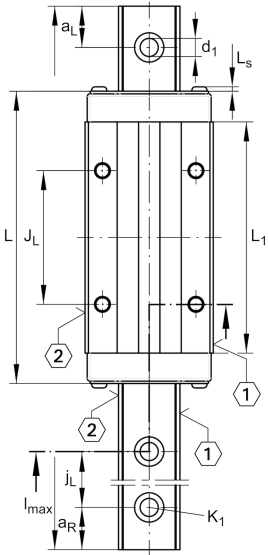
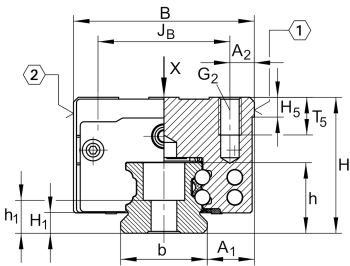

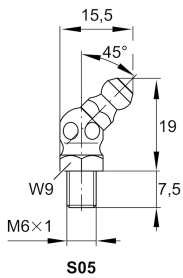
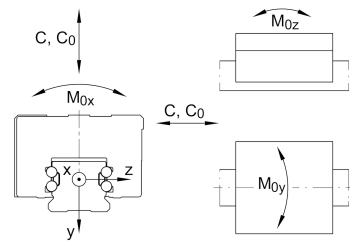
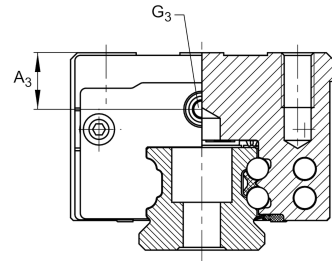
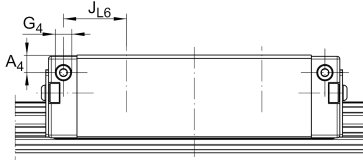

Mounting dimensions

| | | |
|------------------------------|---------|--|
| A ₁ | 12,5 mm | Distance from locating edge on carriage to locating edge on guideway |
| J _B | 35 mm | |
| b | 23 mm | Width rail |
| A ₂ | 6,5 mm | Distance from locating edge to hole |
| L ₁ | 86,5 mm | |
| L _S | 1,65 mm | |
| J _L | 50 mm | |
| H ₁ | 5,1 mm | Free space, system dimension |
| H ₅ | 5,25 mm | |
| T ₅ | 7,5 mm | Thread depth |
| G ₂ | M6 | Fixing screws above (DIN ISO 4762-12.9) |
| G _{2 M_A} | 17 Nm | Maximum tightening torque |
| A ₃ | 6 mm | Position lubrication connector |
| G ₃ | M6 | Lubrication connector |
| t _{G₃} | 7 mm | Maximum permissible screw depth for lubrication connectors |
| A ₄ | 4 mm | Position lubrication connector |
| G ₄ | M3 | Lubrication connector |
| t _{G₄} | 6 mm | Maximum permissible screw depth for lubrication connectors |
| J _{L6} | 22,5 mm | Position lubrication connector |

Additional information

| | | |
|----------|------|---------------|
| VMKB_065 | KWVE | Material name |
|----------|------|---------------|