



KWVE25-B-ES [↗](#)

Recirculating ball bearing carriage

Carriages KWVE...-B-ES, carriage for four-row linear ball bearing and guideway assembly, expanded type, narrow design

Technical information

Your current product variant

Size	25
Version	B
Carriage design	ES Expanded design, narrow carriage

Main Dimensions & Performance Data

H	33 mm	Height system
B	48 mm	Width carriage
L	83,3 mm	Overall length carriage
C	17.900 N	Dynamic load rating
C ₀	37.000 N	Static load rating
M _{0x}	510 Nm	Static moment rating about X axis
M _{0y}	395 Nm	Static moment rating about Y axis
M _{0z}	395 Nm	Static moment rating about Z axis
≈m	0,56 kg	Weight

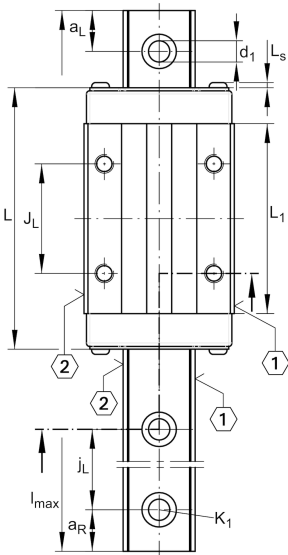
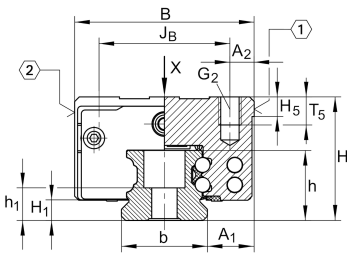

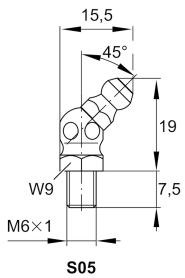
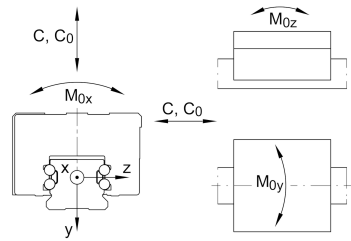
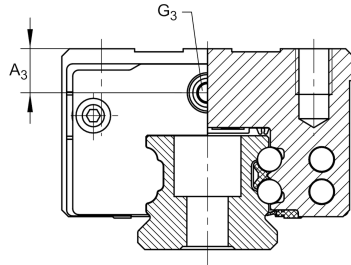
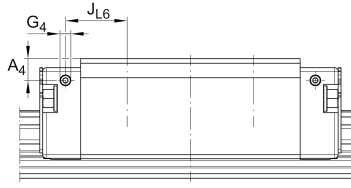

Mounting dimensions

A ₁	12,5 mm	Distance from locating edge on carriage to locating edge on guideway
J _B	35 mm	
b	23 mm	Width rail
A ₂	6,5 mm	Distance from locating edge to hole
L ₁	60,7 mm	
L _S	1,65 mm	
J _L	35 mm	
H ₁	5,2 mm	Free space, system dimension
H ₅	5,25 mm	
T ₅	10 mm	Thread depth
G ₂	M6	Fixing screws above (DIN ISO 4762-12.9)
G _{2 M_A}	17 Nm	Maximum tightening torque
D ₂	6,8 mm	
A ₃	11 mm	Position lubrication connector
G ₃	M6	Lubrication connector
t _{G₃}	7 mm	Maximum permissible screw depth for lubrication connectors
A ₄	6,5 mm	Position lubrication connector
G ₄	M3	Lubrication connector
t _{G₄}	7 mm	Maximum permissible screw depth for lubrication connectors
J _{L6}	12,85 mm	Position lubrication connector

Additional information

VMKB_065	KWVE	Material name
----------	------	---------------