

**GYE35-XL-KRR-B-AS2/V**

Radial insert ball bearing

Radial insert ball bearings GYE...-KRR-B, spherical outer ring, location by grub screws, R seals on both sides

X-life

Technical information

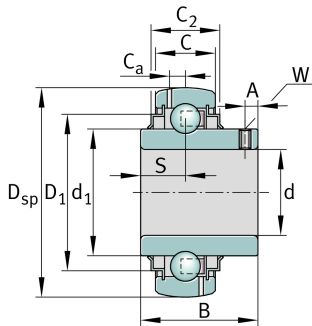

Your current product variant

Lubrication hole transposed AS2/V

Main Dimensions & Performance Data

d	35 mm	Bore diameter
D _{SP}	72 mm	Outside diameter
B	42,9 mm	Width
C _{0r}	15.300 N	Basic static load rating, radial
C _{ur}	650 N	Fatigue load limit, radial
C _r	25.500 N	Basic dynamic load rating, radial
≈m	0,437 kg	Weight

Dimensions

C	19 mm	Width, outer ring
C ₂	22,5 mm	Sealing total width
S	17,5 mm	Distance raceway
d ₁	46,8 mm	Rib diameter inner ring
D ₁	60,3 mm	Outside diameter seal
C _a	5,6 mm	Distance to lubrication hole
A	6 mm	Distance thread
W	3 mm	Width of flats







Temperature range

T_{\min}	-20 °C	Operating temperature min.
T_{\max}	100 °C	Operating temperature max.

Calculation factors

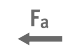
f_0	13,8	Calculation factor
-------	------	--------------------

Characteristics

-  Radial load
-  Axial load in one direction
-  Axial load in two directions
-  Lifetime lubrication, freedom from maintenance
-  Grease Lubrication
-  Sealed on both sides
-  Static angular error and misalignment