



### KUVE30-B

#### Ball monorail guidance system

Carriages KWVE...-B, standard carriage, four-row, full complement ball set

## Technical information

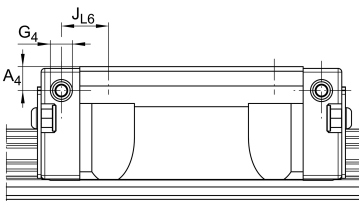
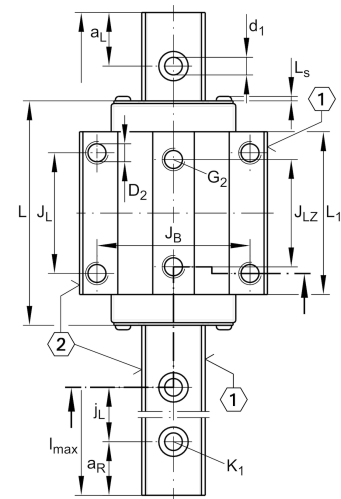

### Your current product variant

Size code	30	
Carriage design	Standard	Standard carriage
Version	B	

### Main dimensions

$l_{max}$	5.860 mm	Max length single piece guideway
H	42 mm	Height system
B	90 mm	Width carriage
L	99 mm	Overall length carriage

### Technical data

C	27.500 N	Dynamic load rating
$C_0$	55.000 N	Static load rating
$M_{0x}$	970 Nm	Static moment rating about X axis
$M_{0y}$	700 Nm	Static moment rating about Y axis
$M_{0z}$	700 Nm	Static moment rating about Z axis

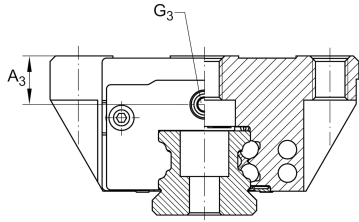

### Mounting dimensions

A <sub>1</sub>	31 mm	Distance from locating edge on carriage to locating edge on guideway
J <sub>B</sub>	72 mm	
b	28 mm	Width rail
Tol <sub>b</sub>	-0,005 mm	Upper tolerance
Tol <sub>b</sub>	-0,03 mm	Lower tolerance
A <sub>2</sub>	9 mm	Distance from locating edge to hole
L <sub>1</sub>	72 mm	
L <sub>s</sub>	1,65 mm	
J <sub>L</sub>	52 mm	
J <sub>LZ</sub>	44 mm	
j <sub>L</sub>	80 mm	
a <sub>L min</sub>	20 mm	
a <sub>L max</sub>	71 mm	
a <sub>R min</sub>	20 mm	
a <sub>R max</sub>	71 mm	
H <sub>1</sub>	5,9 mm	Free space, system dimension
H <sub>4</sub>	13,8 mm	
H <sub>5</sub>	6,25 mm	
T <sub>5</sub>	12 mm	Thread depth
T <sub>6</sub>	11,5 mm	
h	23,5 mm	
h <sub>1</sub>	11 mm	
G <sub>2</sub>	M10	Fixing screws
G <sub>2 MA</sub>	41 Nm	Maximum tightening torque
K <sub>1</sub>	M8	Fixing screws
K <sub>1 MA</sub>	41 Nm	Maximum tightening torque
K <sub>3</sub>	M8	Fixing screws
K <sub>6</sub>	M8	Fixing screws

The data sheet only contains an overview of the technical data of the selected product. Please refer to the additional documentation for this product. For further information, please use the following link on our website: [Contact form](#)



View product details on medias

14.05.2026, 20:24:41 UTC

SCHAEFFLER

### Related products

---

KWVE30-B

Compatible with the following carriage

TKVD30

Suitable Guide Rail