

**KUV35-B-SL**

Ball monorail guidance system

Carriages KWVE...-B-SL, narrow, long carriage, four-row

Technical information

Your current product variant

Size code	35	
Carriage design	SL	Narrow, long carriage
Version	B	

Main dimensions

l_{max}	5.860 mm	Max length single piece guideway
H	48 mm	Height system
B	70 mm	Width carriage
L	145 mm	Overall length carriage

Technical data

C	47.500 N	Dynamic load rating
C_0	100.000 N	Static load rating
M_{0x}	2.625 Nm	Static moment rating about X axis
M_{0y}	1.890 Nm	Static moment rating about Y axis
M_{0z}	1.890 Nm	Static moment rating about Z axis

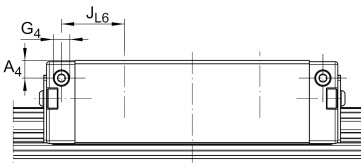
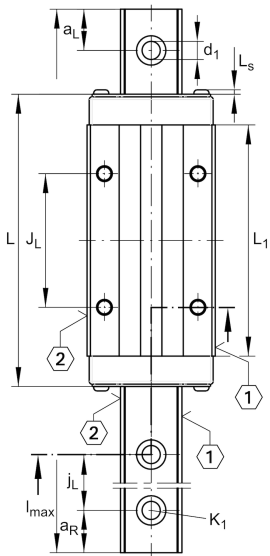
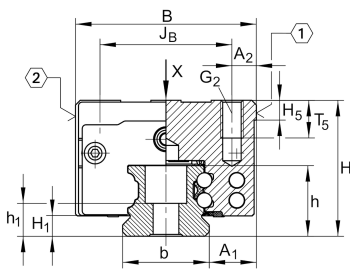

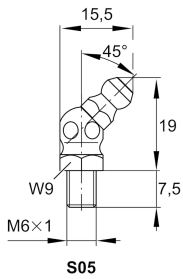
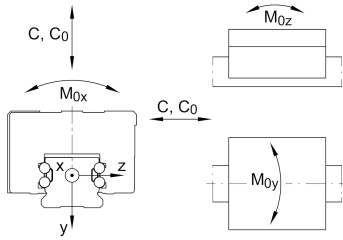
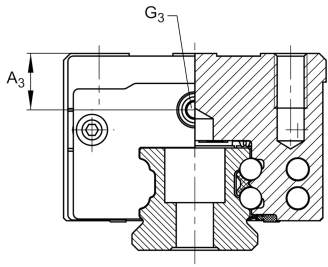

Mounting dimensions

A ₁	18 mm	Distance from locating edge on carriage to locating edge on guideway
J _B	50 mm	
b	34 mm	Width rail
Tol _b	-0,005 mm	Upper tolerance
Tol _b	-0,03 mm	Lower tolerance
A ₂	10 mm	Distance from locating edge to hole
L ₁	113 mm	
L _s	2,2 mm	
J _L	72 mm	
j _L	80 mm	
a _{L min}	20 mm	
a _{L max}	71 mm	
a _{R min}	20 mm	
a _{R max}	71 mm	
H ₁	6,7 mm	Free space, system dimension
H ₅	6,75 mm	
T ₅	13,5 mm	Thread depth
h	27 mm	
h ₁	14,5 mm	
G ₂	M8	Fixing screws
G _{2 MA}	41 Nm	Maximum tightening torque
K ₁	M8	Fixing screws
K _{1 MA}	41 Nm	Maximum tightening torque
d ₁	9 mm	
A ₃	12,3 mm	
G ₃	M6	
t _{G3}	7 mm	

The data sheet only contains an overview of the technical data of the selected product. Please refer to the additional documentation for this product. For further information, please use the following link on our website: [Contact form](#)



View product details on medias

12.06.2026, 02:52:25 UTC

SCHAEFFLER

Related products

KWVE35-B-SL

Compatible with the following carriage

TKVD35

Suitable Guide Rail