

**FAG****SES209-L**

Plummer block housing

Split plummer block housing for various bearing designs. The SNV series will be replaced by the new SES series in 2022.

Technical information

**Main Dimensions & Performance Data**

D	85 mm	Outside diameter bearing
a	205 mm	Length base
h ₁	109 mm	Height
g	85 mm	Width housing body
K	30 mm	Width bearing seat
≈m	2,93 kg	Weight



Dimensions

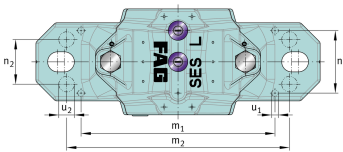
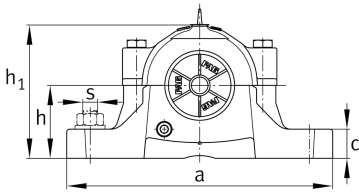

b	60 mm	Width base
c	25 mm	Height base
h	60 mm	Base to shaft centerline height
m	170 mm	Distance fixing bore
s	12,7 mm	Screw size
s	M12	Size of fixing screws
u	15 mm	Width slot
v	20 mm	Length slot
D ₂	67 mm	Diameter sealing
D ₃	75,5 mm	Diameter sealing groove
D ₅	73,7 mm	Outside diameter sealing labyrinth
g ₁	5 mm	Width sealing groove
g ₂	67 mm	Distance sealing
g ₃	12 mm	Wall thickness
g ₄	30 mm	Distance oil lubrication
m ₁	138 mm	Distance holes aligned pins m1
n ₃	45 mm	Distance lubrication
n ₄	71 mm	Distance lubrication sealing
u ₁	4 mm	Bore diameter u1
u ₂	11 mm	Bore diameter u2