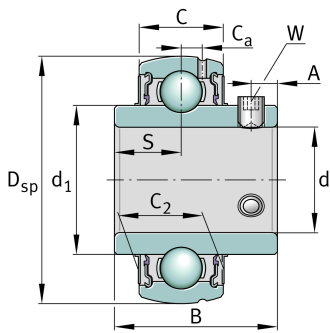

**GYE25-KRR-B-FA107-VA-FD**

Radial insert ball bearing

Technical information

**Main Dimensions & Performance Data**

d	25 mm	Bore diameter
D _{SP}	52 mm	Outside diameter
B	34,1 mm	Width
C _{0r}	7.500 N	Basic static load rating, radial
C _{ur}	335 N	Fatigue load limit, radial
C _r	13.400 N	Basic dynamic load rating, radial
≈m	0,21 kg	Weight

Dimensions

C	17 mm	Width, outer ring
S	14,3 mm	Distance raceway
d ₁	34 mm	Rib diameter inner ring
C _a	4,15 mm	Distance to lubrication hole
A	5 mm	Distance thread
W	2,5 mm	Width of flats

Temperature range

T _{min}	-30 °C	Operating temperature min.
T _{max}	100 °C	Operating temperature max.



Calculation factors

f_0	13,8	Calculation factor
-------	------	--------------------

Characteristics

-  Radial load
-  Axial load in one direction
-  Axial load in two directions
-  Lifetime lubrication, freedom from maintenance
-  Grease Lubrication
-  Sealed on both sides
-  Protected against rust
-  Static angular error and misalignment