

LTE20-130-A-OA-0 [↗](#)

Linear table

Linear tables with closed shaft guidance system, without drive, with shaft support block type A, without bellows

Technical information

Your current product variant

Size code	20	
Length of carriage	130	130 mm
Version	A	
Drive type	OA	Without drive
Bellow	0	No

Main Dimensions & Performance Data

B ₁	130 mm	Total Width
H	48 mm	Total Height
L	130 mm	Length of Carriage

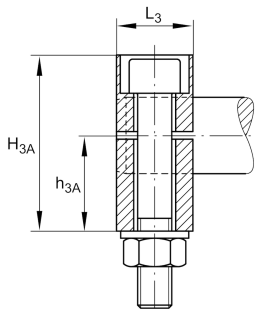
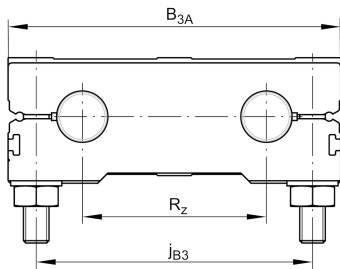

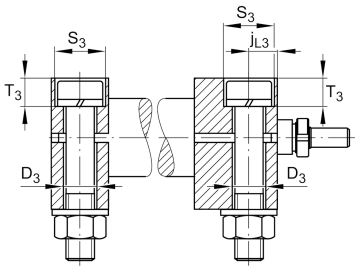
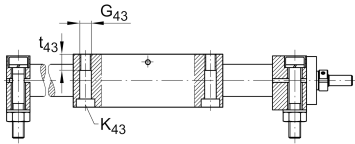
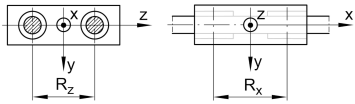
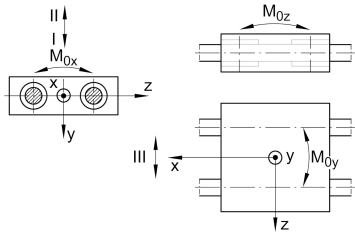

Technical data

R X	74,6 mm	
R Z	72 mm	
S	0 mm	Safety Distance
m LAW	1,8 kg	Mass of Carriage
v max	5 m/s	Maximum Speed
a max	50 m/s ²	Maximum Acceleration
C I	4.140 N	Load direction I: compressive load
C 0I	4.920 N	Load direction I: compressive load
C II	4.140 N	Load direction II: tensile load
C 0II	4.920 N	Load direction II: tensile load
C III	4.140 N	Load direction III: lateral load
C 0III	4.920 N	Load direction III: lateral load
M 0x per	178 Nm	Max. permissible static moment per Carriage
M 0y per	155 Nm	Max. permissible static moment per Carriage
M 0z per	138 Nm	Max. permissible static moment per Carriage

Additional information

KB20-P	Linear Ball Bearings
--------	----------------------

Temperature range

0 °C	Minimum operating Temperatur
80 °C	Maximum operating Temperatur