



LTE20-130-A-OA-1 [↗](#)

Linear table

Linear tables with closed shaft guidance system, without drive, with shaft support block type A, with bellows

Technical information

Your current product variant

Size code	20	
Length of carriage	130	130 mm
Version	A	
Drive type	OA	Without drive
Bellow	1	Yes

Main Dimensions & Performance Data

B ₁	130 mm	Total Width
H	48 mm	Total Height
L	130 mm	Length of Carriage

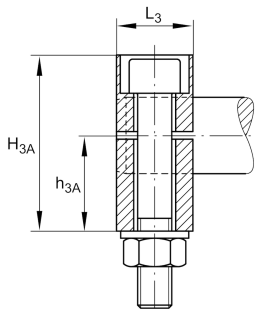
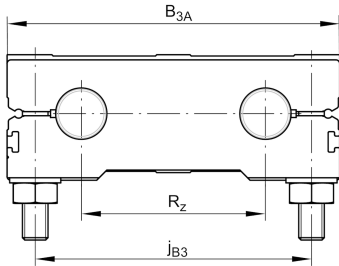

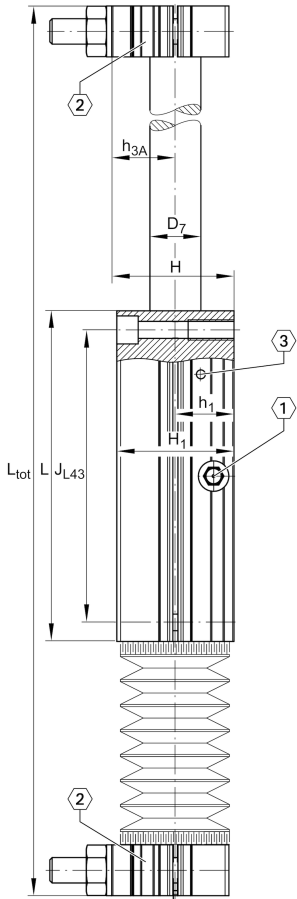

Mounting dimensions

B_{3A}	130 mm	Width of Shaft Support Blocks
D_3	11 mm	
G_{43}	M8	Thread
J_{B43}	115 mm	
J_{L43}	115 mm	
j_{B3}	108 mm	
j_{L3}	10 mm	
K_{43}	M6	Thread
S_3	18 mm	
T_3	10 mm	
t_{43}	18 mm	Depth of Thread

Dimensions

B_B	20 mm	Length of Bellows Fastener
F_{BL}	1,33	Effective length factor of bellow
H_1	46 mm	Height of Carriage
H_{3A}	46 mm	Height of Shaft Support Blocks
h_1	23 mm	
h_{3A}	25 mm	
L_3	20 mm	Length of Shaft Support Blocks
D_7	20 mm	\varnothing Shaft, Tolerance h7

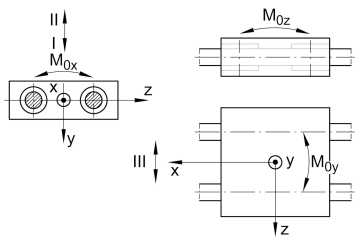
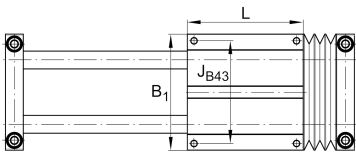

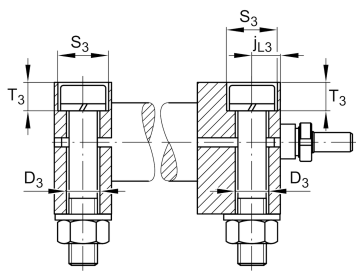
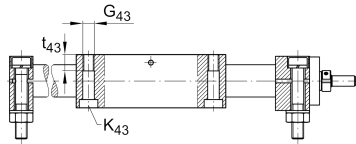
**Technical data**

R _x	74,6 mm	
R _z	72 mm	
S	0 mm	Safety Distance
m _{LAW}	1,8 kg	Mass of Carriage
v _{max}	5 m/s	Maximum Speed
a _{max}	50 m/s ²	Maximum Acceleration
C _I	4.140 N	Load direction I: compressive load
C _{0I}	4.920 N	Load direction I: compressive load
C _{II}	4.140 N	Load direction II: tensile load
C _{0II}	4.920 N	Load direction II: tensile load
C _{III}	4.140 N	Load direction III: lateral load
C _{0III}	4.920 N	Load direction III: lateral load
M _{0x per}	178 Nm	Max. permissible static moment per Carriage
M _{0y per}	155 Nm	Max. permissible static moment per Carriage
M _{0z per}	138 Nm	Max. permissible static moment per Carriage

Additional information

KB20-P	Linear Ball Bearings
--------	----------------------

Temperature range

0 °C	Minimum operating Temperatur
80 °C	Maximum operating Temperatur