

**RSHEY20-TV-VA-FD**

Plummer block housing unit

Plummer block housing units, FD design

## Technical information

## Your current product variant

Special material	TV	Plastic housing
Corrosion resistant bearing	VA	Corrosion-resistant VA design
Material	TV-FD	Plastic for food industry

## Main Dimensions &amp; Performance Data

d	20 mm	Bore diameter
L	72,8 mm	Length
H <sub>2</sub>	66 mm	Height
≈m	0,27 kg	Weight

## Mounting dimensions

J	50,8 mm	Distance fixing bore
K	M8	Thread fixing bore
W	2,5 mm	Width of flats

## Dimensions

H	33,3 mm	Distance shaft axis
A	34,5 mm	Width (base)
B	31 mm	Width
B <sub>3</sub>	32,35 mm	Distance housing centre to cap end
S <sub>1</sub>	18,3 mm	Distance raceway to locking collar
Q	1/4"-28 UNF	Connection thread for lubrication

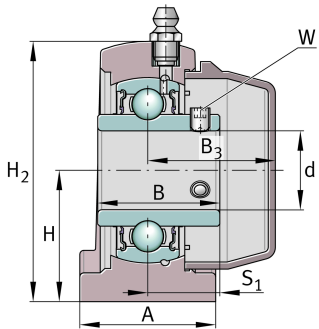
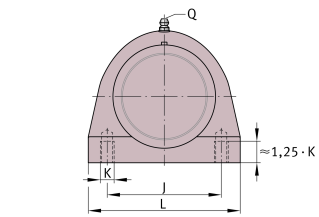



### Additional information

GEH.SHE04-TV-WHT	Housing
GYE20-KRR-B-FA107-VA-FD	Bearing designation
KASK04-S-G-WHT	End cap
KASK04-S-R-NBR-WHT	Open protecting cap

### Temperature range

T <sub>min</sub>	-30 °C	Operating temperature min.
T <sub>max</sub>	100 °C	Operating temperature max.