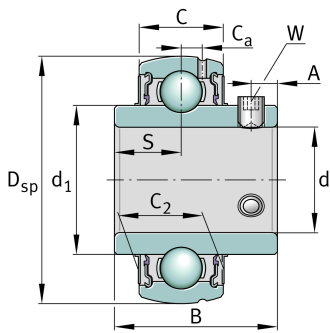

**GYE20-KRR-B-FA107-VA-FD**

Radial insert ball bearing

## Technical information

**Main Dimensions & Performance Data**

d	20 mm	Bore diameter
D <sub>SP</sub>	47 mm	Outside diameter
B	31 mm	Width
C <sub>0r</sub>	6.600 N	Basic static load rating, radial
C <sub>ur</sub>	280 N	Fatigue load limit, radial
C <sub>r</sub>	12.800 N	Basic dynamic load rating, radial
≈m	0,16 kg	Weight

**Dimensions**

C	16 mm	Width, outer ring
S	12,7 mm	Distance raceway
d <sub>1</sub>	28,3 mm	Rib diameter inner ring
C <sub>a</sub>	4 mm	Distance to lubrication hole
A	5 mm	Distance thread
W	2,5 mm	Width of flats

**Temperature range**

T <sub>min</sub>	-30 °C	Operating temperature min.
T <sub>max</sub>	100 °C	Operating temperature max.



### Calculation factors

---

$f_0$	13,1	Calculation factor
-------	------	--------------------

### Characteristics

---

-  Radial load
-  Axial load in one direction
-  Axial load in two directions
-  Lifetime lubrication, freedom from maintenance
-  Grease Lubrication
-  Sealed on both sides
-  Protected against rust
-  Static angular error and misalignment