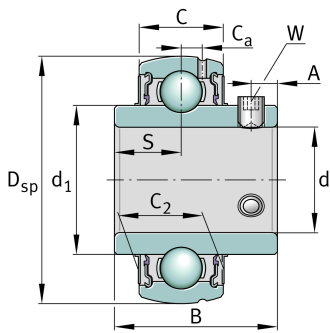

**GYE35-KRR-B-FA107-VA-FD**

Radial insert ball bearing

## Technical information

**Main Dimensions & Performance Data**

d	35 mm	Bore diameter
D <sub>SP</sub>	72 mm	Outside diameter
B	42,9 mm	Width
C <sub>0r</sub>	14.600 N	Basic static load rating, radial
C <sub>ur</sub>	655 N	Fatigue load limit, radial
C <sub>r</sub>	24.600 N	Basic dynamic load rating, radial
≈m	0,46 kg	Weight

**Dimensions**

C	20 mm	Width, outer ring
S	17,5 mm	Distance raceway
d <sub>1</sub>	46,9 mm	Rib diameter inner ring
C <sub>a</sub>	5,7 mm	Distance to lubrication hole
A	6,5 mm	Distance thread
W	3 mm	Width of flats

**Temperature range**

T <sub>min</sub>	-30 °C	Operating temperature min.
T <sub>max</sub>	100 °C	Operating temperature max.



### Calculation factors

---

$f_0$	13,8	Calculation factor
-------	------	--------------------

### Characteristics

---

-  Radial load
-  Axial load in one direction
-  Axial load in two directions
-  Lifetime lubrication, freedom from maintenance
-  Grease Lubrication
-  Sealed on both sides
-  Protected against rust
-  Static angular error and misalignment