

**FAG****S6204-2Z>N**

## Deep groove ball bearing

Deep groove ball bearing S62...-2Z, corrosion-resistant materials, single row, shields, steel sheet metal cage

## Technical information

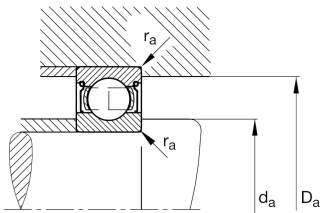
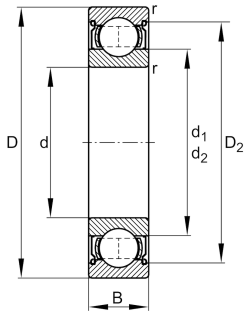

## Your current product variant

Version code	>N	Not marked on bearing
Material Bearing	S	Stainless steel
Sealing	2Z	Non-contact shield on both sides
Cage	JN	Steel sheet metal
Tolerance class	PN	Normal (PN)
Dimensional / heat stabilization	SN	Rings dimensional stabilized up to 120°
Lubricant	Lubricating grease	
Radial internal clearance	CN (Group N)	Normal internal clearance
Bore type	Z	Cylindrical

## Main Dimensions &amp; Performance Data

d	20 mm	Bore diameter
D	47 mm	Outside diameter
B	14 mm	Width
C <sub>r</sub>	13.600 N	Basic dynamic load rating, radial
C <sub>0r</sub>	6.700 N	Basic static load rating, radial
C <sub>ur</sub>	415 N	Fatigue load limit, radial
n <sub>G</sub>	18.300 1/min	Limiting speed
n <sub>gr</sub>	15.500 1/min	Reference speed
≈m	106 g	Weight



### Mounting dimensions

$d_{a \min}$	25,6 mm	Minimum diameter shaft shoulder
$D_{a \max}$	41,1 mm	Maximum diameter of housing shoulder
$r_{a \max}$	1 mm	Maximum fillet radius

### Dimensions

$r_{\min}$	1 mm	Minimum chamfer dimension
$D_1$	39,7 mm	Shoulder diameter outer ring
$D_2$	41,15 mm	Caliber diameter outer ring
$d_1$	29,3 mm	Shoulder diameter inner ring







### Temperature range

$T_{\min}$	-30 °C	Operating temperature min.
$T_{\max}$	120 °C	Operating temperature max.

### Calculation factors

$f_0$	13,3	Calculation factor
-------	------	--------------------

### Characteristics

	Radial load
	Axial load in one direction
	Axial load in two directions
	Lifetime lubrication, freedom from maintenance
	Grease Lubrication
	Sealed on both sides
	Protected against rust