



LOCKNUT-HOOK-KM31-34 [↗](#)

Locknut hook wrench

for locknuts KM



Technical information

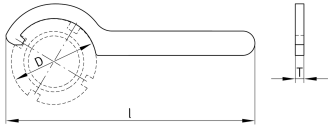

Your current product variant

Version	SW	Single wrench
---------	----	---------------

Dimensions

D _{min}	205 mm	
D _{max}	220 mm	
l	470 mm	
T	10 mm	
m	1,58 kg	Weight

Additional information

1 pc. hook wrench	Scope of delivery
—	Part of LOCKNUT-HOOK-KM0-16-SET
KM31, KM32, KM33, KM34	Suitable for locknuts