



LOCKNUT-HOOK-KM7 [↗](#)

Locknut hook wrench

for locknuts KM



Technical information

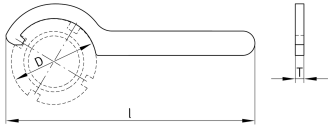

Your current product variant

Version	SW	Single wrench
---------	----	---------------

Dimensions

D _{min}	52 mm	
D _{max}	55 mm	
l	206 mm	
T	6 mm	
≈m	160 g	Weight

Additional information

1 pc. hook wrench	Scope of delivery
+	Part of LOCKNUT-HOOK-KM0-16-SET
KM7	Suitable for locknuts