



## LOCKNUT-SOCKET-KM10 [↗](#)

Groove nut socket wrench

for locknuts and precision locknuts

### Technical information

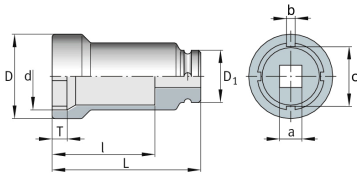

#### Dimensions

d	70,7 mm	
D	78,5 mm	
D <sub>1</sub>	44 mm	
L	90 mm	
I	60 mm	
T	13,5 mm	
a	3/4"	Square (inch)
b	5,7 mm	
c	65,8 mm	
≈m	0,87 kg	Weight

#### Additional information

KM10	Suitable for locknuts
ZMA35/70, ZM50	Suitable for precision locknuts
1 pc. socket wrench with locking pin and rubber washer	Included in delivery