



LOCKNUT-SOCKET-KM13 [↗](#)

Groove nut socket wrench

for locknuts and precision locknuts

Technical information

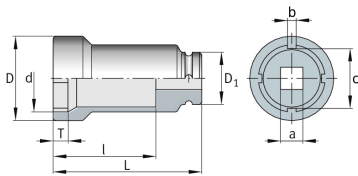

Dimensions

d	85,7 mm	
D	94 mm	
D ₁	44 mm	
L	90 mm	
I	60 mm	
T	13,5 mm	
a	3/4"	Square (inch)
b	6,7 mm	
c	79,8 mm	
≈m	1,09 kg	Weight

Additional information

KM13	Suitable for locknuts
ZMA45/85, ZM65	Suitable for precision locknuts
1 pc. socket wrench with locking pin and rubber washer	Included in delivery