



LOCKNUT-SOCKET-KM3 [↗](#)

Groove nut socket wrench

for locknuts and precision locknuts

Technical information

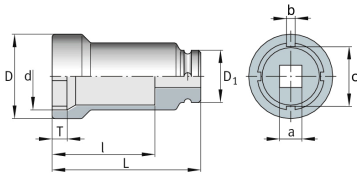

Dimensions

d	28,4 mm	
D	36 mm	
D ₁	30 mm	
L	82 mm	
I	65 mm	
T	6 mm	
a	1/2"	Square (inch)
b	3,5 mm	
c	24,6 mm	
≈m	0,24 kg	Weight

Additional information

KM3	Suitable for locknuts
ZM17	Suitable for precision locknuts
1 pc. socket wrench with locking pin and rubber washer	Included in delivery