

**GAKL12-PW** [↗](#)

## Rod end

Rod end GAKL...-PW, external threads, maintenance-free

## Technical information

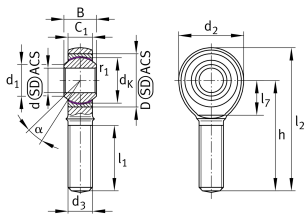

## Your current product variant

Clampable	Not clampable
Mounting	External thread
Grease nipples	Cannot be relubricated
Slotted	No
Thread Pitch	Left-hand thread
Maintenance	Maintenance free
Type of Seal	Without
Material sliding Layer	Sliding foil

## Main Dimensions &amp; Performance Data

d <sub>2</sub>	32 mm	Outer diameter eye
C <sub>r</sub>	24.000 N	Basic dynamic load rating
C <sub>0r</sub>	20.800 N	Basic static load rating
d	12 mm	Bore diameter bearing
D	26 mm	Outside diameter bearing
l <sub>2</sub>	70 mm	Total length
B	16 mm	Width inner ring
≈m	0,11 kg	Weight



### Dimensions

$d_k$	22,225 mm	Ball diameter
$d_1$	15,4 mm	Outer flange diameter inner ring
$d_3$	M12	Thread size
$h$	54 mm	Length of thread
$C_1$	12 mm	Width of the rod end
$\alpha$	13 °	Tilt angle
$l_1$	32 mm	Thread length
$B_{UT}$	-0,12 mm	Width inner ring , lower tolerance
$B_{OT}$	0 mm	Width inner ring; upper tolerance
$d_T$	H7	Bore diameter_bearing_tolerance
$d_{UT}$	0 mm	Bore diameter, lower tolerance
$d_{OT}$	0,018 mm	Bore diameter bearing upper tolerance
$G_r$	0 - 0,035	Radial clearance
$G_{rmax}$	0,035 mm	Radial clearance, maximum
$G_{rmin}$	0 mm	Radial clearance, minimum

### Temperature range

$T_{min}$	-50 °C	Operating temperature min.
$T_{max}$	200 °C	Operating temperature max.

### Mounting dimensions

$r_{1s}$	0,3 mm	Smallest single chamfer dimension, inner ring
----------	--------	---



## Characteristics

---



Radial load



Lifetime lubrication, freedom from maintenance



Not sealed



Static angular error and misalignment



Dynamic angular error and misalignment