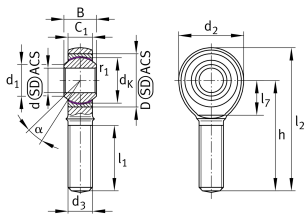

**GAKL16-PW** [↗](#)

Rod end

Rod end GAKL...-PW, external threads, maintenance-free

Technical information

**Your current product variant**

Clampable	Not clampable
Mounting	External thread
Grease nipples	Cannot be relubricated
Slotted	No
Thread Pitch	Left-hand thread
Maintenance	Maintenance free
Type of Seal	Without
Material sliding Layer	Sliding foil

Main Dimensions & Performance Data

d_2	42 mm	Outer diameter eye
C_r	38.600 N	Basic dynamic load rating
C_{0r}	45.300 N	Basic static load rating
d	16 mm	Bore diameter bearing
D	32 mm	Outside diameter bearing
l_2	87 mm	Total length
B	21 mm	Width inner ring
$\approx m$	0,227 kg	Weight



Dimensions

d_k	28,575 mm	Ball diameter
d_1	19,3 mm	Outer flange diameter inner ring
d_3	M16	Thread size
h	66 mm	Length of thread
C_1	15 mm	Width of the rod end
α	15 °	Tilt angle
l_1	37 mm	Thread length
l_7	23 mm	Length of the flat surface from the bearing bore centre to the shank
B_{UT}	-0,12 mm	Width inner ring , lower tolerance
B_{OT}	0 mm	Width inner ring; upper tolerance
d_T	H7	Bore diameter_bearing_tolerance
d_{UT}	0 mm	Bore diameter, lower tolerance
d_{OT}	0,018 mm	Bore diameter bearing upper tolerance
G_r	0 - 0,035	Radial clearance
G_{rmax}	0,035 mm	Radial clearance, maximum
G_{rmin}	0 mm	Radial clearance, minimum

Temperature range

T_{min}	-50 °C	Operating temperature min.
T_{max}	200 °C	Operating temperature max.

Mounting dimensions

r_{1s}	0,3 mm	Smallest single chamfer dimension, inner ring
----------	--------	---



Characteristics



Radial load



Lifetime lubrication, freedom from maintenance



Not sealed



Static angular error and misalignment



Dynamic angular error and misalignment