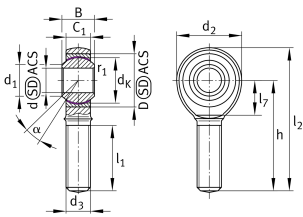

**GAKL20-PW** [↗](#)

Rod end

Rod end GAKL...-PW, external threads, maintenance-free

Technical information

**Your current product variant**

Clampable	Not clampable
Mounting	External thread
Grease nipples	Cannot be relubricated
Slotted	No
Thread Pitch	Left-hand thread
Maintenance	Maintenance free
Type of Sealing	Without
Material sliding Layer	Sliding foil

Main Dimensions & Performance Data

d ₂	50 mm	Outer diameter eye
C _r	56.600 N	Basic dynamic load rating
C _{0r}	45.600 N	Basic static load rating
d	20 mm	Bore diameter bearing
D	40 mm	Outside diameter bearing
l ₂	103 mm	Total length
B	25 mm	Width inner ring
≈m	0,376 kg	Weight



Dimensions

d_k	34,925 mm	Ball diameter
d_1	24,3 mm	Outer flange diameter inner ring
d_3	M20x1,5	Thread size
h	78 mm	Length of thread
C_1	18 mm	Width of the rod end
α	14 °	Tilt angle
l_1	45 mm	Thread length
l_7	26 mm	Length of the flat surface from the bearing bore centre to the shank
B_{UT}	-0,12 mm	Width inner ring , lower tolerance
B_{OT}	0 mm	Width inner ring; upper tolerance
d_T	H7	Bore diameter_bearing_tolerance
d_{UT}	0 mm	Bore diameter, lower tolerance
d_{OT}	0,021 mm	Bore diameter bearing upper tolerance
G_r	0 - 0,035	Radial clearance
G_{rmax}	0,035 mm	Radial clearance, maximum
G_{rmin}	0 mm	Radial clearance, minimum

Temperature range

T_{min}	-50 °C	Operating temperature min.
T_{max}	200 °C	Operating temperature max.

Mounting dimensions

r_{1s}	0,3 mm	Smallest single chamfer dimension, inner ring
----------	--------	---



Characteristics



Radial load



Lifetime lubrication, freedom from maintenance



Not sealed



Static angular error and misalignment



Dynamic angular error and misalignment