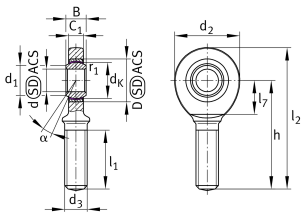

**GAR20-UK**

Rod end

Rod end with external thread, right hand thread, maintenance-free, sliding layer: PTFE composite, DIN ISO 12240-4, dimension series E, type M, inner ring curved surface with hard chromium coating, open design

Technical information

**Your current product variant**

Clampable	Not clampable
Mounting	External thread
Grease nipples	Cannot be relubricated
Slotted	No
Thread Pitch	Right-hand thread
Maintenance	Maintenance free
Sealing	Without

Main Dimensions & Performance Data

d_2	53 mm	Outer diameter eye
C_r	31.300 N	Basic dynamic load rating
C_{0r}	75.600 N	Basic static load rating
d	20 mm	Bore diameter bearing
D	35 mm	Outside diameter bearing
l_2	104,5 mm	Total length
B	16 mm	Width inner ring
$\approx m$	0,327 kg	Weight



Dimensions

d_k	29 mm	Ball diameter
d_1	24,1 mm	Outer flange diameter inner ring
d_3	M20x1,5	Thread size
h	78 mm	Length of thread
C_1	13 mm	Width of the rod end
α	9 °	Tilt angle
l_1	43 mm	Thread length
l_7	27 mm	Length of the flat surface from the bearing bore centre to the shank
B_{UT}	-0,12 mm	Width inner ring , lower tolerance
B_{OT}	0 mm	Width inner ring; upper tolerance
d_{UT}	-0,01 mm	Bore diameter, lower tolerance
d_{OT}	0 mm	Bore diameter bearing upper tolerance
G_r	0 - 0,04	Radial clearance
G_{rmax}	0,04 mm	Radial clearance, maximum
G_{rmin}	0 mm	Radial clearance, minimum

Temperature range

T_{min}	-50 °C	Operating temperature min.
T_{max}	200 °C	Operating temperature max.

Mounting dimensions

r_{1s}	0,3 mm	Smallest single chamfer dimension, inner ring
----------	--------	---



Characteristics



Radial load



Lifetime lubrication, freedom from maintenance



Not sealed



Static angular error and misalignment



Dynamic angular error and misalignment