

**GAR12-DO**

Rod end



Rod end with external thread, right hand thread, requiring maintenance, sliding contact surface: steel/steel, DIN ISO 12240-4, dimension series E, type M, open

Technical information

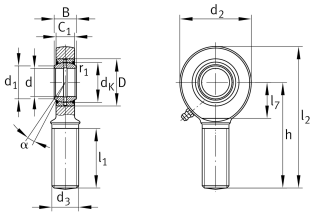

Your current product variant

Clampable	Not clampable	
Maintenance	Maintenance required	
Mounting	External thread	
Lubrication nipple	Cannot be relubricated	
Slotted	No	
Thread Pitch	Right-hand thread	
Type of Seal	Without	
Radial internal clearance	CN (Group N)	Normal internal clearance

Main Dimensions & Performance Data

C_r	13.900 N	Basic dynamic load rating, radial
C_{0r}	30.200 N	Basic static load rating, radial
d	12 mm	Bore diameter bearing
D	22 mm	Outside diameter bearing
l_2	71 mm	Total length external thread head
B	10 mm	Width inner ring
d_2	34 mm	Outer eye diameter
$\approx m$	77,5 g	Weight



Mounting dimensions

d ₁	14,9 mm	Outer flange diameter inner ring
r _{1smin}	0,3 mm	Edge Spacing

Dimensions

d _K	18 mm	Ball diameter
d ₃	M12	Thread size
h	54 mm	Shank Length External thread rod
C ₁	8 mm	Width of the rod end
α	11 °	Tilt angle
l ₁	28 mm	Shank Length External thread head
l ₇	18 mm	Distance drilling with/shaft start
d _{OT}	0 mm	Bore diameter bearing, upper tolerance
d _{UT}	-0,008 mm	Bore diameter bearing, lower tolerance
B _{OT}	0 mm	Width inner ring, upper tolerance
B _{UT}	-0,12 mm	Width inner ring, lower tolerance
G _r	0,023 - 0,068	Radial Clearance
G _{rmax}	0,068 mm	Radial clearance, maximum
G _{rmin}	0,023 mm	Radial clearance, minimum

Temperature range

T _{min}	-60 °C	Operating temperature min.
T _{max}	200 °C	Operating temperature max.



Characteristics



Radial load



Grease Lubrication



Not sealed



Static angular error and misalignment



Dynamic angular error and misalignment