

**GAR17-DO**

Rod end



Rod end with external thread, right hand thread, requiring maintenance, sliding contact surface: steel/steel, DIN ISO 12240-4, dimension series E, type M, open

Technical information

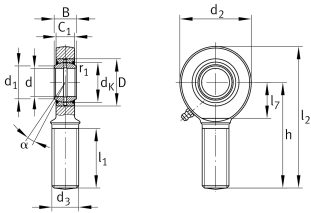

Your current product variant

| | | |
|---------------------------|----------------------|---------------------------|
| Clampable | Not clampable | |
| Maintenance | Maintenance required | |
| Mounting | External thread | |
| Lubrication nipple | Lubrication hole | |
| Slotted | No | |
| Thread Pitch | Right-hand thread | |
| Type of Seal | Without | |
| Radial internal clearance | CN (Group N) | Normal internal clearance |

Main Dimensions & Performance Data

| | | |
|-------------|----------|-----------------------------------|
| C_r | 27.600 N | Basic dynamic load rating, radial |
| C_{0r} | 56.500 N | Basic static load rating, radial |
| d | 17 mm | Bore diameter bearing |
| D | 30 mm | Outside diameter bearing |
| l_2 | 92 mm | Total length external thread head |
| B | 14 mm | Width inner ring |
| d_2 | 46 mm | Outer eye diameter |
| $\approx m$ | 0,202 kg | Weight |



Mounting dimensions

| | | |
|--------------------|---------|----------------------------------|
| d ₁ | 20,7 mm | Outer flange diameter inner ring |
| r _{1smin} | 0,3 mm | Edge Spacing |

Dimensions

| | | |
|-------------------|--------------|--|
| d _K | 25 mm | Ball diameter |
| d ₃ | M16 | Thread size |
| h | 69 mm | Shank Length External thread rod |
| C ₁ | 11 mm | Width of the rod end |
| α | 10 ° | Tilt angle |
| l ₁ | 36 mm | Shank Length External thread head |
| l ₇ | 23 mm | Distance drilling with/shaft start |
| d _{OT} | 0 mm | Bore diameter bearing, upper tolerance |
| d _{UT} | -0,008 mm | Bore diameter bearing, lower tolerance |
| B _{OT} | 0 mm | Width inner ring, upper tolerance |
| B _{UT} | -0,12 mm | Width inner ring, lower tolerance |
| G _r | 0,03 - 0,082 | Radial Clearance |
| G _{rmax} | 0,082 mm | Radial clearance, maximum |
| G _{rmin} | 0,03 mm | Radial clearance, minimum |

Temperature range

| | | |
|------------------|--------|----------------------------|
| T _{min} | -60 °C | Operating temperature min. |
| T _{max} | 200 °C | Operating temperature max. |



Characteristics



Radial load



Grease Lubrication



Not sealed



Static angular error and misalignment



Dynamic angular error and misalignment