

**GIR17-DO-2RS**

Rod end



Rod end with internal thread, right hand thread, requiring maintenance, sliding contact surface: steel/steel, DIN ISO 12240-4, dimension series E, type F, sealed

Technical information

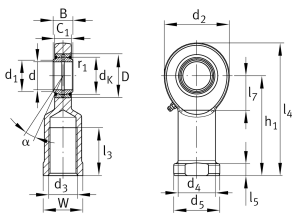

Your current product variant

Clampable	Not clampable	
Maintenance	Maintenance required	
Lubrication nipple	Lubrication hole	
Slotted	No	
Thread Pitch	Right-hand thread	
Sealing	2RS	Lip seals on both sides
Radial internal clearance	CN (Group N)	Normal internal clearance
Mounting	Internal thread	

Main Dimensions & Performance Data

d	17 mm	Bore diameter bearing
D	30 mm	Outside diameter bearing
B	14 mm	Width inner ring
C _r	27.600 N	Basic dynamic load rating, radial
C _{0r}	56.500 N	Basic static load rating, radial
G _r	0,030 - 0,082	Radial Clearance
≈m	250 g	Weight



Dimensions

d _K	25 mm	Ball diameter
d ₁	20,7 mm	Outer flange diameter inner ring
d ₂	46 mm	Outer eye diameter
d ₃	M16	Thread size
d ₄	24 mm	Shank diameter
h ₁	67 mm	Shank Length Internal thread head
C ₁	11 mm	Width of the rod end
α	10 °	Tilt angle
l ₃	34 mm	Thread length Internal thread
l ₄	90 mm	Total length internal thread head
l ₅	10 mm	Length rod end shank
l ₇	23 mm	Distance drilling with/shaft start
d ₅	30 mm	Shank diameter, large
r _{1smin}	0,3 mm	Edge Spacing
W	27 mm	Width Across Flat
d _{OT}	0 mm	Bore diameter bearing, upper tolerance
d _{UT}	-0,008 mm	Bore diameter bearing, lower tolerance
B _{OT}	0 mm	Width inner ring, upper tolerance
B _{UT}	-0,12 mm	Width inner ring, lower tolerance
G _{rmax}	0,082 mm	Radial clearance, maximum
G _{rmin}	0,03 mm	Radial clearance, minimum

Temperature range

T _{min}	-30 °C	Operating temperature min.
T _{max}	130 °C	Operating temperature max.



Characteristics



Radial load



Grease Lubrication



Sealed on both sides



Static angular error and misalignment



Dynamic angular error and misalignment