

**GIR30-DO-2RS**

Rod end



Rod end with internal thread, right hand thread, requiring maintenance, sliding contact surface: steel/steel, DIN ISO 12240-4, dimension series E, type F, sealed

Technical information

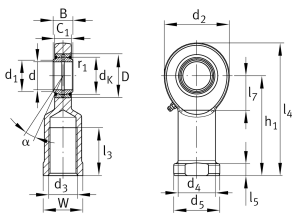

Your current product variant

Clampable	Not clampable	
Maintenance	Maintenance required	
Mounting	Internal thread	
Lubrication nipple	DIN71412-AS6 (tapered grease nipple)	
Slotted	No	
Thread Pitch	Right-hand thread	
Type of Seal	2RS	Lip seals on both sides
Radial internal clearance	CN (Group N)	Normal internal clearance

Main Dimensions & Performance Data

d	30 mm	Bore diameter bearing
D	47 mm	Outside diameter bearing
B	22 mm	Width inner ring
C _r	81.000 N	Basic dynamic load rating, radial
C _{0r}	119.000 N	Basic static load rating, radial
G _r	0,037 - 0,1	Radial Clearance
≈m	0,944 kg	Weight



Dimensions

d _K	40,7 mm	Ball diameter
d ₁	34,2 mm	Outer flange diameter inner ring
d ₂	73 mm	Outer eye diameter
d ₃	M30x2	Thread size
d ₄	40 mm	Shank diameter
h ₁	110 mm	Shank Length Internal thread head
C ₁	19 mm	Width of the rod end
α	6 °	Tilt angle
l ₃	56 mm	Thread length Internal thread
l ₄	146,5 mm	Total length internal thread head
l ₅	15 mm	Length rod end shank
l ₇	37 mm	Distance drilling with/shaft start
d ₅	50 mm	Shank diameter, large
r _{1smin}	0,6 mm	Edge Spacing
W	41 mm	Width Across Flat
d _{OT}	0 mm	Bore diameter bearing, upper tolerance
d _{UT}	-0,01 mm	Bore diameter bearing, lower tolerance
B _{OT}	0 mm	Width inner ring, upper tolerance
B _{UT}	-0,12 mm	Width inner ring, lower tolerance
G _{rmax}	0,1 mm	Radial clearance, maximum
G _{rmin}	0,037 mm	Radial clearance, minimum

Temperature range

T _{min}	-30 °C	Operating temperature min.
T _{max}	130 °C	Operating temperature max.



Characteristics



Radial load



Grease Lubrication



Sealed on both sides



Static angular error and misalignment



Dynamic angular error and misalignment